

# CERTIFICATE

Certified Passive House Component

Component-ID 0205fx03 valid until 31st December 2017

Passive House Institute  
Dr. Wolfgang Feist  
64283 Darmstadt  
Germany

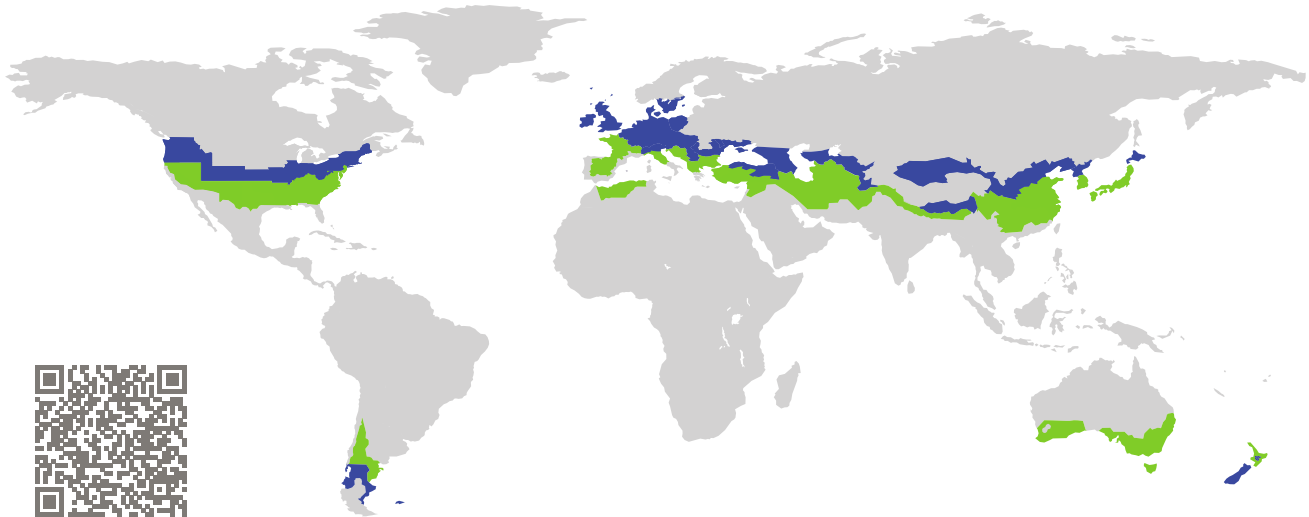

Category: **Fixed window**  
Manufacturer: **batimet GmbH,  
Dresden,  
Germany**  
Product name: **TA35 SE Festverglasung**

**This certificate was awarded based on the following  
criteria for the cool, temperate climate zone**

Comfort  $U_W = 0.78 \leq 0.80 \text{ W}/(\text{m}^2 \text{ K})$   
 $U_{W,\text{installed}} \leq 0.85 \text{ W}/(\text{m}^2 \text{ K})$   
with  $U_g = 0.70 \text{ W}/(\text{m}^2 \text{ K})$

Hygiene  $f_{Rsi=0.25} \geq 0.70$

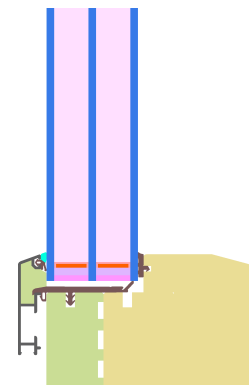

Passive House  
efficiency class

phE

phD

phC

phB

phA

cool, temperate climate



**CERTIFIED  
COMPONENT**

Passive House Institute

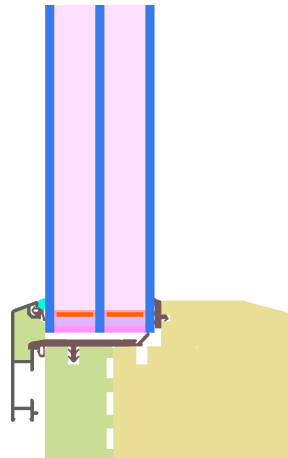

Calculation model

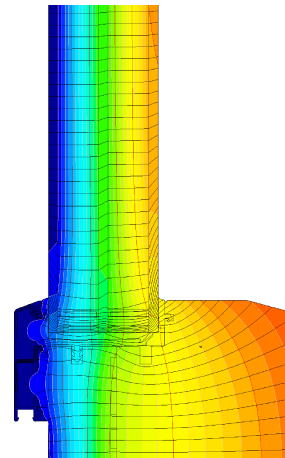

Isothermal

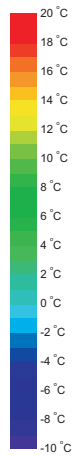

### Description

Timber frame for fixed glazing, insulated by PE-foam (0,036 W/(mK). Aluminium cladding for rain protection. Pane thickness: 48 mm (4/18/4/18/4), Rebate depth: 14 mm.

### Explanation





The window U-values were calculated for the test window size of 1.23 m × 1.48 m with  $U_g = 0.70$  W/(m<sup>2</sup> K). If a higher quality glazing is used, the window U-values will improve as follows:

Glazing	$U_g =$	0.70	0.64	0.58	0.53	W/(m <sup>2</sup> K)
		↓	↓	↓	↓	
Window	$U_W =$	0.78	0.73	0.68	0.64	W/(m <sup>2</sup> K)

Transparent building components are classified into efficiency classes depending on the heat losses through the opaque part. The frame U-Values, frame widths, thermal bridges at the glazing edge, and the glazing edge lengths are included in these heat losses. A more detailed report of the calculations performed in the context of certification is available from the manufacturer.

The Passive House Institute has defined international component criteria for seven climate zones. In principle, components which have been certified for climate zones with higher requirements may also be used in climates with less stringent requirements. In a particular climate zone it may make sense to use a component of a higher thermal quality which has been certified for a climate zone with more stringent requirements.

Further information relating to certification can be found on [www.passivehouse.com](http://www.passivehouse.com) and [passipedia.org](http://passipedia.org).

Frame values			Frame width $b_f$ mm	$U$ -value frame $U_f$ W/(m <sup>2</sup> K)	$\Psi$ -glass edge $\Psi_g$ W/(m K)	Temp. Factor $f_{Rsi=0.25}$ [-]
Top fixed	(tof)		70	0.73	0.027	0.71
Side fixed	(sf)		70	0.73	0.027	0.71
Bottom fixed	(bof)		70	0.77	0.027	0.71
Mullion fixed	(m)		110	0.73	0.027	0.71
			Spacer: SWISSPACER V		Secondary seal: Polysulfide	

## Validated installations

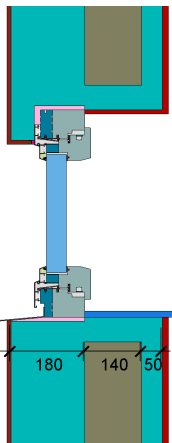
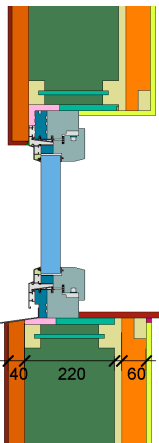
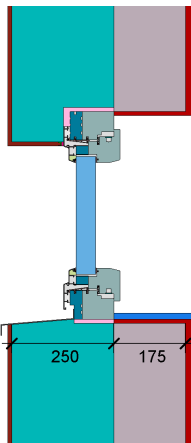
Insulated formwork blocks		Timber frame		EIFS	
					
$\Psi_{install}$	W/(m K)	$\Psi_{install}$	W/(m K)	$\Psi_{install}$	W/(m K)
Top	0.006	Top	0.009	Top	0.010
Side	0.006	Side	0.009	Side	0.010
Bottom	0.012	Bottom	0.014	Bottom	0.017
$U_{W,installed} = 0.80$ W/(m <sup>2</sup> K)		$U_{W,installed} = 0.81$ W/(m <sup>2</sup> K)		$U_{W,installed} = 0.81$ W/(m <sup>2</sup> K)	

