

# CERTIFICATE

Certified Passive House Component

Component-ID 0898wi03 valid until 31st December 2017

Passive House Institute  
Dr. Wolfgang Feist  
64283 Darmstadt  
Germany

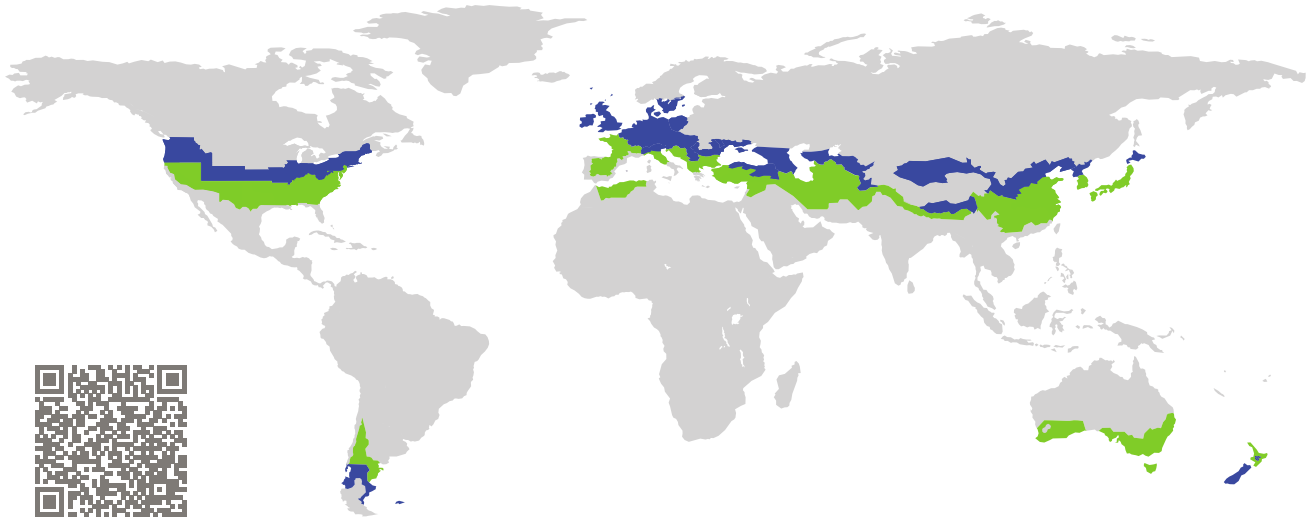

Category: **Window frame**  
Manufacturer: **pro Passivhausfenster GmbH,  
Oberaudorf,  
Germany**  
Product name: **smartwin solar**

**This certificate was awarded based on the following  
criteria for the cool, temperate climate zone**

Comfort  $U_W = 0.78 \leq 0.80 \text{ W}/(\text{m}^2 \text{ K})$   
 $U_{W,\text{installed}} \leq 0.85 \text{ W}/(\text{m}^2 \text{ K})$   
with  $U_g = 0.70 \text{ W}/(\text{m}^2 \text{ K})$

Hygiene  $f_{Rsi=0.25} \geq 0.70$

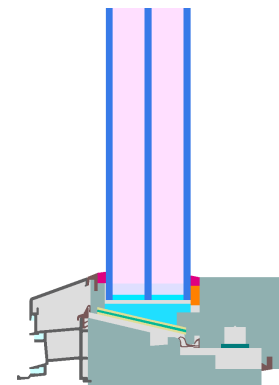

Passive House  
efficiency class

phE

phD

phC

phB

phA

cool, temperate climate



**CERTIFIED  
COMPONENT**

Passive House Institute

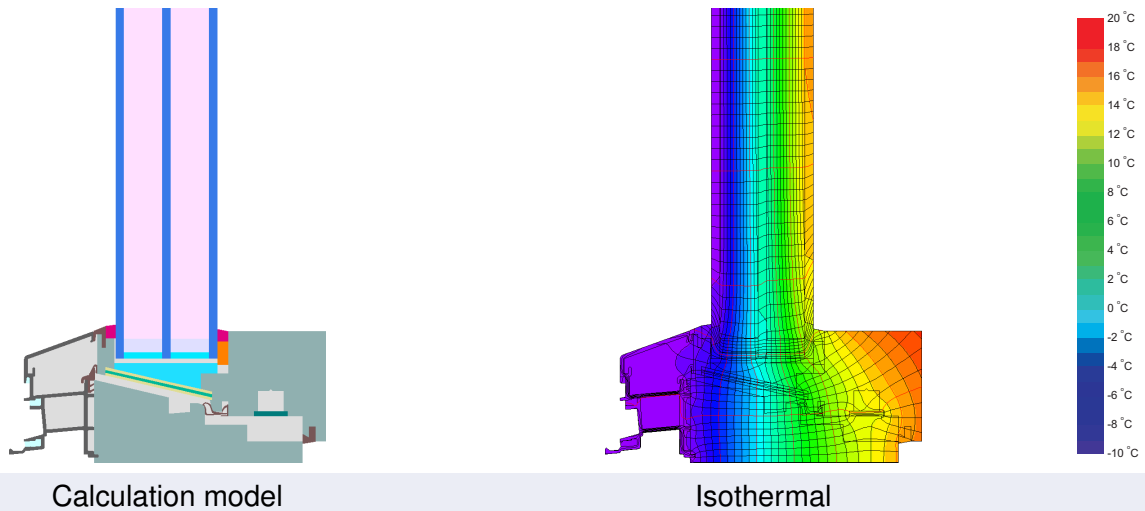

### Description

Timber-Aluminum window frame (spruce/fir 0.11 W/(mK) with PU insulation (0.027 W/(mK) in the sash. Glass loads are carried by special corner pieces. Pane thickness: 48 mm (4/18/4/18/4), rebate depth: 13 mm, spacer: SWISSPACER Ultimate with polyurethane as secondary seal

### Explanation





The window U-values were calculated for the test window size of 1.23 m × 1.48 m with  $U_g = 0.70$  W/(m<sup>2</sup> K). If a higher quality glazing is used, the window U-values will improve as follows:

Glazing	$U_g =$	0.70	0.64	0.58	0.52	W/(m <sup>2</sup> K)
		↓	↓	↓	↓	
Window	$U_W =$	0.78	0.73	0.68	0.63	W/(m <sup>2</sup> K)

Transparent building components are classified into efficiency classes depending on the heat losses through the opaque part. The frame U-Values, frame widths, thermal bridges at the glazing edge, and the glazing edge lengths are included in these heat losses. A more detailed report of the calculations performed in the context of certification is available from the manufacturer.

The Passive House Institute has defined international component criteria for seven climate zones. In principle, components which have been certified for climate zones with higher requirements may also be used in climates with less stringent requirements. In a particular climate zone it may make sense to use a component of a higher thermal quality which has been certified for a climate zone with more stringent requirements.

Further information relating to certification can be found on [www.passivehouse.com](http://www.passivehouse.com) and [passipedia.org](http://passipedia.org).

Frame values			Frame width $b_f$ mm	$U$ -value frame $U_f$ W/(m <sup>2</sup> K)	$\Psi$ -glass edge $\Psi_g$ W/(m K)	Temp. Factor $f_{Rsi=0.25}$ [-]
Top	(to)		62	0.83	0.020	0.74
Side	(s)		62	0.83	0.020	0.74
Bottom	(bo)		62	0.93	0.020	0.73
Mullion 1 casement	(m1)		80	0.87	0.021	0.72
			Spacer: SWISSPACER Ultimate		Secondary seal: Polyurethane	

### Validated installations

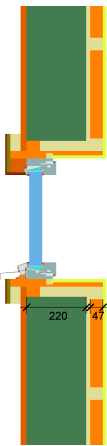
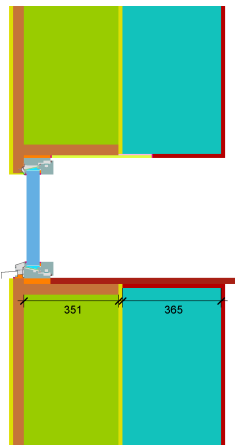
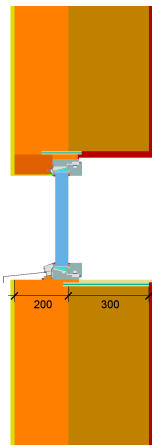
Timber frame		smartshell reno		EIFS	
$U_{Wall} = 0.14$ W/(m <sup>2</sup> K)		$U_{Wall} = 0.10$ W/(m <sup>2</sup> K)		$U_{Wall} = 0.12$ W/(m <sup>2</sup> K)	
					
$\Psi_{install}$	W/(m K)	$\Psi_{install}$	W/(m K)	$\Psi_{install}$	W/(m K)
Top	0.017	Top	0.022	Top	0.013
Side	0.017	Side	0.022	Side	0.013
Bottom	0.024	Bottom	0.028	Bottom	0.023
$U_{W,installed} = 0.84$ W/(m <sup>2</sup> K)		$U_{W,installed} = 0.85$ W/(m <sup>2</sup> K)		$U_{W,installed} = 0.83$ W/(m <sup>2</sup> K)	

