

# CERTIFICATE

Certified Passive House Component

Component-ID 0095wi03 valid until 31st December 2017

Passive House Institute  
Dr. Wolfgang Feist  
64283 Darmstadt  
Germany

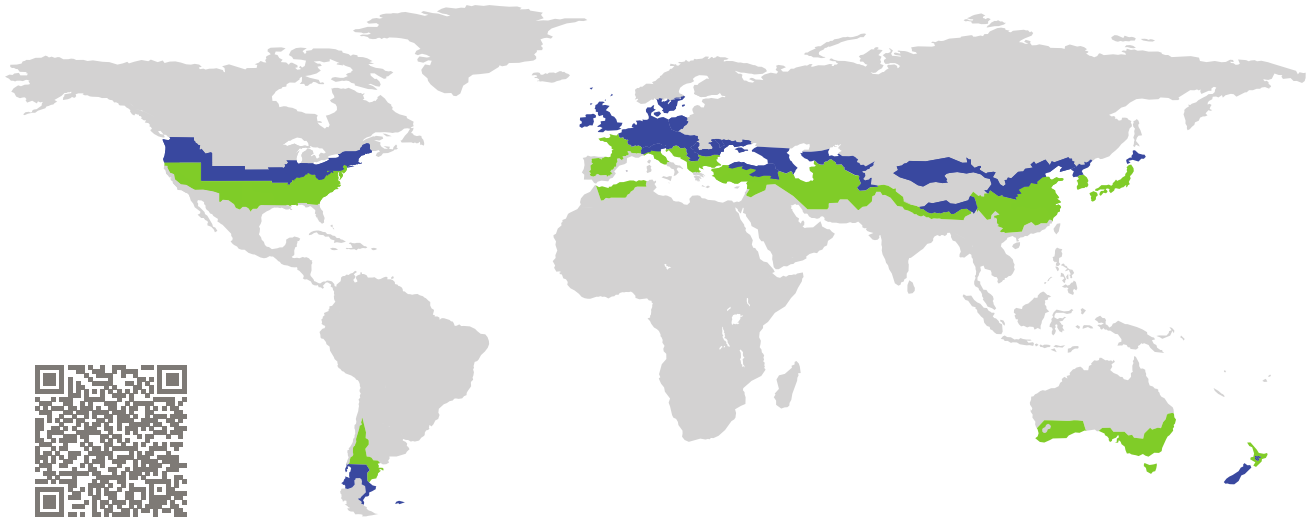

Category: **Window frame (Coupled Window)**  
Manufacturer: **TROHA-DIL d.o.o.,  
Severin,  
Croatia**  
Product name: **BLUEGREEN Plus**

**This certificate was awarded based on the following  
criteria for the cool, temperate climate zone**

Comfort  $U_W = 0.73 \leq 0.80 \text{ W}/(\text{m}^2 \text{ K})$   
 $U_{W,\text{installed}} \leq 0.85 \text{ W}/(\text{m}^2 \text{ K})$   
with  $U_g^1 = 0.62 \text{ W}/(\text{m}^2 \text{ K})$

Hygiene  $f_{Rsi=0.20} \geq 0.70$

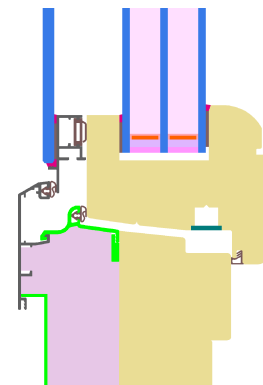

<sup>1</sup>The specified  $U_g$  value is determined using the reference glazing of the climate zone in conjunction with the additional pane.

Passive House  
efficiency class

phE

phD

phC

phB

phA

cool, temperate climate



**CERTIFIED  
COMPONENT**

Passive House Institute

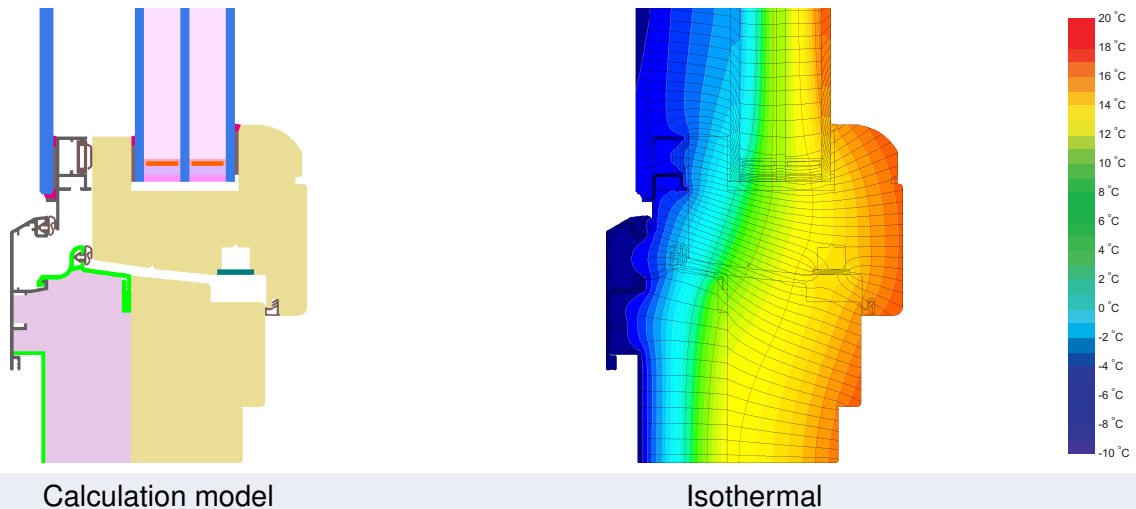

## Description

Timber frame with insulation and external aluminium shell; coupled window with  $U_g = 0.62 \text{ W}/(\text{m}^2\text{K})$  (triple glazing  $U_g = 0.70 \text{ W}/(\text{m}^2\text{K})$  plus one additional pane (6 mm), 36 mm spacing); insure use of glazing with appropriate g-values

## Explanation

The window U-values were calculated for the test window size of  $1.23 \text{ m} \times 1.48 \text{ m}$  with  $U_g = 0.70 \text{ W}/(\text{m}^2 \text{K})$ . If a higher quality glazing is used, the window U-values will improve as follows:



Glazing <sup>2</sup>	$U_g =$	0.70	0.64	0.58	0.53	$\text{W}/(\text{m}^2 \text{K})$
		↓	↓	↓	↓	
Window	$U_W =$	0.73	0.70	0.67	0.64	$\text{W}/(\text{m}^2 \text{K})$

Transparent building components are classified into efficiency classes depending on the heat losses through the opaque part. The frame U-Values, frame widths, thermal bridges at the glazing edge, and the glazing edge lengths are included in these heat losses. A more detailed report of the calculations performed in the context of certification is available from the manufacturer.

The Passive House Institute has defined international component criteria for seven climate zones. In principle, components which have been certified for climate zones with higher requirements may also be used in climates with less stringent requirements. In a particular climate zone it may make sense to use a component of a higher thermal quality which has been certified for a climate zone with more stringent requirements.

Further information relating to certification can be found on [www.passivehouse.com](http://www.passivehouse.com) and [passipedia.org](http://passipedia.org).

<sup>2</sup>The specified  $U_g$  values refer to the thermally decisive pane.

Frame values			Frame width $b_f$ mm	$U$ -value frame $U_f$ W/(m <sup>2</sup> K)	$\Psi$ -glass edge $\Psi_g$ W/(m K)	Temp. Factor $f_{Rsi=0.20}$ [-]
Top	(to)		124	0.80	0.020	0.82
Side	(s)		124	0.80	0.020	0.82
Bottom	(bo)		149	0.78	0.020	0.82

Spacer: SWISSPACER V      Secondary seal: Polysulfide

### Validated installations

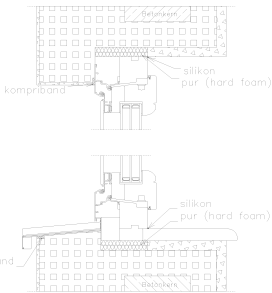
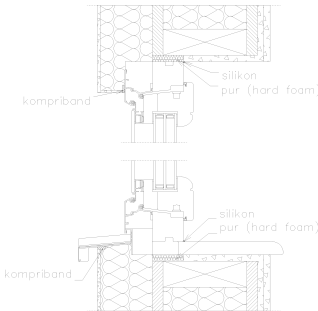
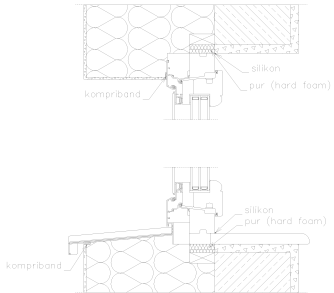
Insulated formwork blocks		Timber frame		EIFS	
					
$\Psi_{install}$	W/(m K)	$\Psi_{install}$	W/(m K)	$\Psi_{install}$	W/(m K)
Top	0.008	Top	0.018	Top	0.014
Side	0.008	Side	0.018	Side	0.014
Bottom	0.013	Bottom	0.023	Bottom	0.018
$U_{W,installed} = 0.76$ W/(m <sup>2</sup> K)		$U_{W,installed} = 0.79$ W/(m <sup>2</sup> K)		$U_{W,installed} = 0.77$ W/(m <sup>2</sup> K)	

