

# CERTIFICATE

Certified Passive House Component

Component-ID 1461wi04 valid until 31st December 2020

Passive House Institute  
Dr. Wolfgang Feist  
64283 Darmstadt  
Germany

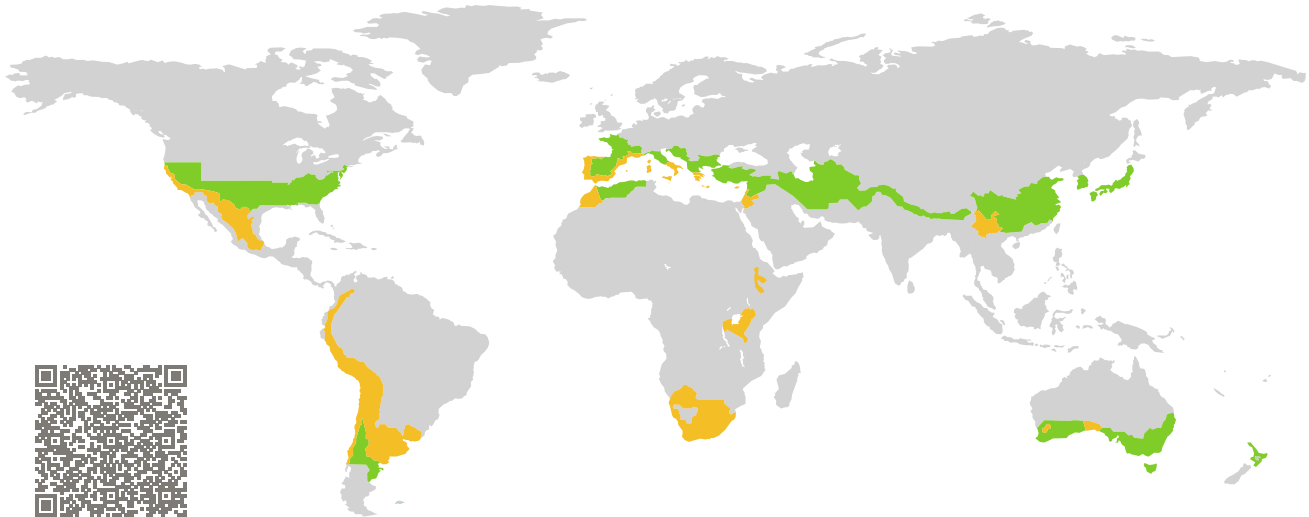

Category: **Window Frame**  
Manufacturer: **Hebei Orient Sundar Window Co., Ltd., Gaobeidian City, Hebei Province, China**  
Product name: **All Climate Passive 126 W+ warm, temperate**

**This certificate was awarded based on the following criteria for the warm, temperate climate zone**

Comfort  $U_W = 0.98 \leq 1.00 \text{ W}/(\text{m}^2 \text{ K})$   
 $U_{W, \text{installed}} \leq 1.05 \text{ W}/(\text{m}^2 \text{ K})$   
with  $U_g = 0.90 \text{ W}/(\text{m}^2 \text{ K})$

Hygiene  $f_{Rsi=0.25} \geq 0.65$

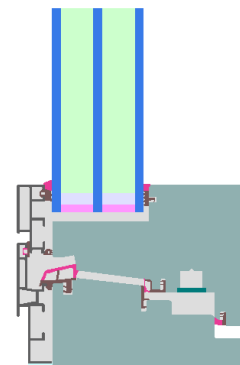

Passive House  
efficiency class

phE

phD

phC

phB

phA

warm, temperate climate



ph B

**CERTIFIED  
COMPONENT**

Passive House Institute

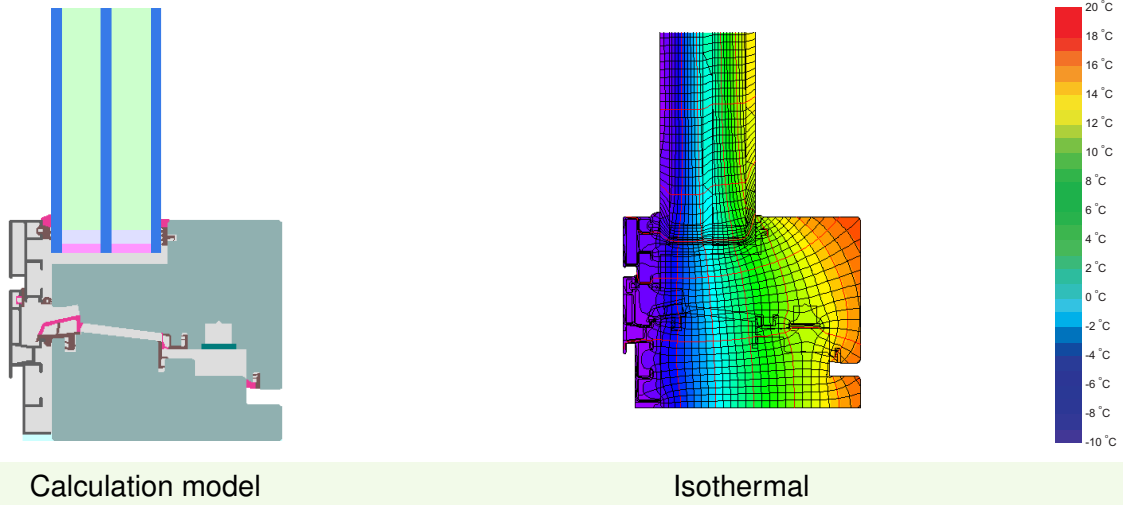

### Description

Timber Aluminium (Spruce/fir 0.11 W/(mK)) window frame. Pane thickness: 51 mm (5/18/5/18/5), rebate depth: 15 mm. Spacer: SWISSPACER Ultimate.

### Explanation





The window U-values were calculated for the test window size of 1.23 m × 1.48 m with  $U_g = 0.90$  W/(m<sup>2</sup> K). If a higher quality glazing is used, the window U-values will improve as follows:

Glazing	$U_g =$	0.90	0.70	0.61	0.52	W/(m <sup>2</sup> K)
		↓	↓	↓	↓	
Window	$U_W =$	0.98	0.83	0.77	0.70	W/(m <sup>2</sup> K)

Transparent building components are classified into efficiency classes depending on the heat losses through the opaque part. The frame U-Values, frame widths, thermal bridges at the glazing edge, and the glazing edge lengths are included in these heat losses. A more detailed report of the calculations performed in the context of certification is available from the manufacturer.

The Passive House Institute has defined international component criteria for seven climate zones. In principle, components which have been certified for climate zones with higher requirements may also be used in climates with less stringent requirements. In a particular climate zone it may make sense to use a component of a higher thermal quality which has been certified for a climate zone with more stringent requirements.

Further information relating to certification can be found on [www.passivehouse.com](http://www.passivehouse.com) and [passipedia.org](http://passipedia.org).

Frame values			Frame width $b_f$ mm	$U$ -value frame $U_f$ W/(m <sup>2</sup> K)	$\Psi$ -panel edge $\Psi_g$ W/(m K)	Temp. Factor $f_{RSi=0.25}$ [-]
Top	(to)		102	0.94	0.026	0.66
Side	(s)		102	0.94	0.026	0.66
Bottom	(bo)		102	0.94	0.026	0.66
Mullion flying	(fm)		102	0.99	0.026	0.66
			Spacer: SWISSPACER Ultimate		Secondary seal: Polysulfid	

## Validated installations

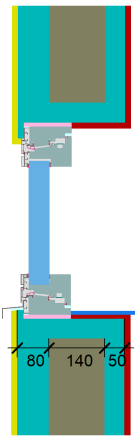
Formwork blocks (operable)	
$U_{Wall} = 0.25 \text{ W/(m}^2 \text{ K)}$	
	
$\Psi_{install}$	W/(m K)
Top	0.008
Side	0.008
Bottom	0.010
$U_{W,installed} = 1.00 \text{ W/(m}^2 \text{ K)}$	

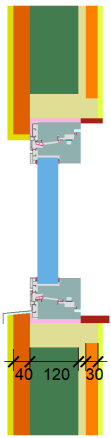
Lightweight timber (operable)	
$U_{Wall} = 0.22 \text{ W/(m}^2 \text{ K)}$	
	
$\Psi_{install}$	W/(m K)
Top	0.017
Side	0.017
Bottom	0.019
$U_{W,installed} = 1.03 \text{ W/(m}^2 \text{ K)}$	

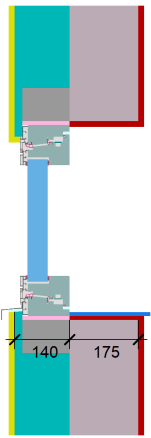
Exterior insulation and finishing system (EIFS) (operable)	
$U_{Wall} = 0.23 \text{ W/(m}^2 \text{ K)}$	
	
$\Psi_{install}$	W/(m K)
Top	0.008
Side	0.008
Bottom	0.011
$U_{W,installed} = 1.00 \text{ W/(m}^2 \text{ K)}$	

