

#### Step 1

Ensure all ISM's are installed: Windows, Doors, Slab Edge etc.

#### Step 2 (Horizontal Method)

For the horizontal method, install from the side of the façade section at the bottom, removing the release liner and adhering the membrane to the sheathing board as it is unrolled. Repeat this step until the façade is covered, overlapping the previous membrane by 100mm.

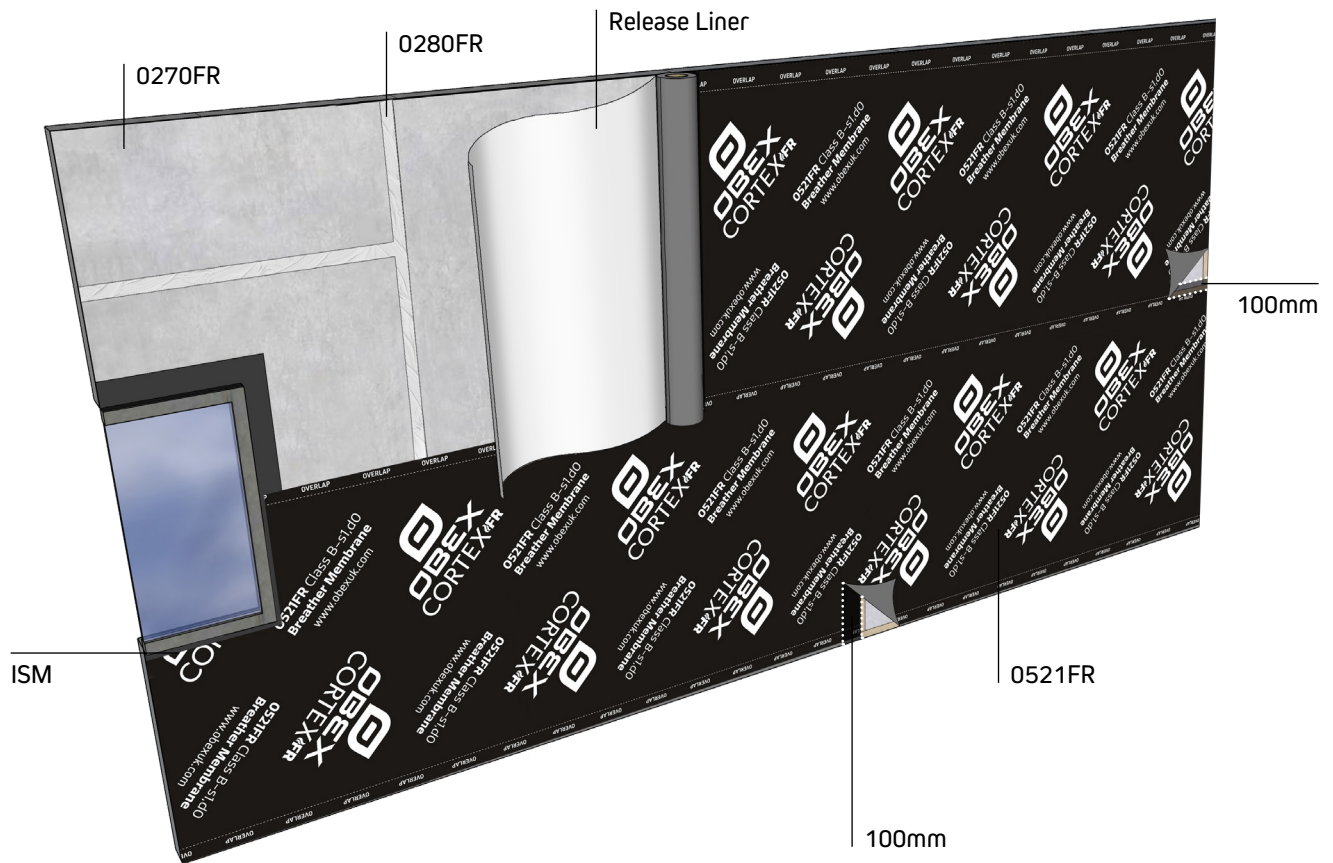

### Step 2 (Vertical Method)

For the vertical method, install from the top of the façade downwards, removing the release liner and adhering the membrane to the sheathing board as it is unrolled. Repeat this step until the façade is covered, overlapping the previous membrane by 100mm.



### Repair Guide

Damages are repaired with a patch of membrane which seals at least 50mm around the damaged area on all sides.