

Pre-wall frame system **VSThermo**
VST 80x90

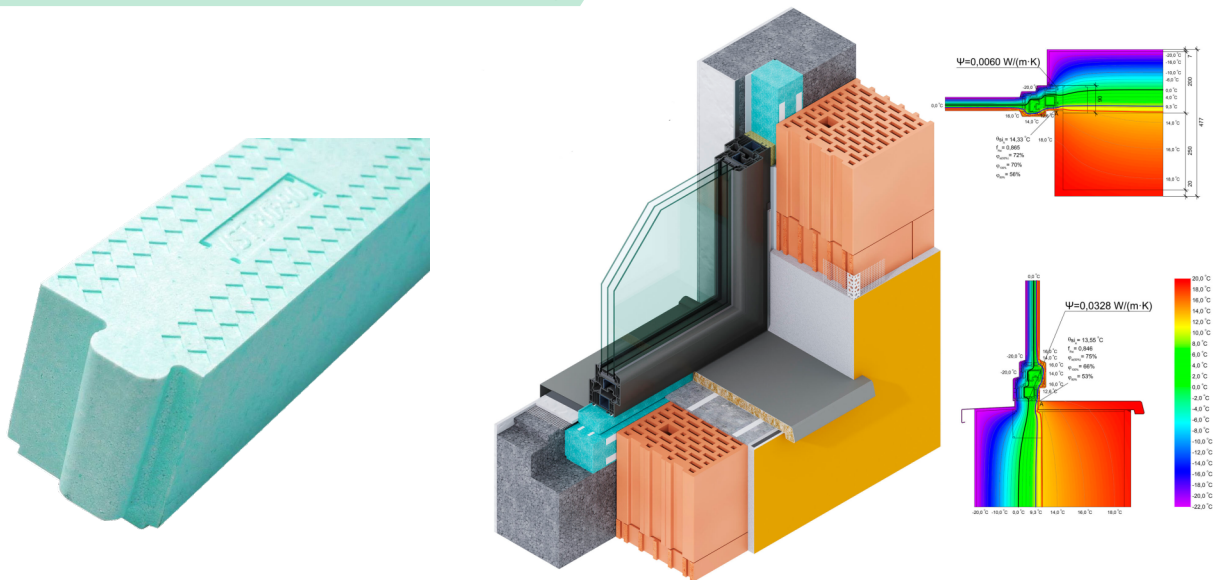

Product description:

The VST 80×90 thermal insulation profile is an ideal solution for Pre-wall installation in the thermal insulation layer of a building. It provides 90 mm extension of the thermal insulation layer of the building relative to the core of the building envelope. The optimal solution for profile systems with an installation width of ≥70 mm.

Application:

For the pre-wall installation in the thermal insulation layer of a building.

Description:

Material.....	EPS
Color.....	Green
Density.....	150 kg/m ³ ± 5%
Thermal conductivity EN 13163:2019.....	0,040 W/(m · K)
Linear dimensions.....	80x90x1200 mm
Operational length.....	1180 mm
Mounting height.....	90 mm
Compressive density (10% of linear deformation) EN 13163:2019.....	≥ 1900 κPa
Fire resistance EN 13501-1:2016.....	Classe E
Water absorption during prolonged full immersion, % by volume EN 13163:2019.....	≤ 1 %

*In accordance with test report No. 272/T/2022, classification report No. 272/2022 of 2.09.2022
Polish Centre for Testing and Certification.*

Preparation for installation.

Before installing the thermal insulation profiles, it is necessary to remove coarse dirt, mortar and adhesive residues from the wall surface. The surface of the substrate must be flat and firm. The substrate must be dry, resistant to crumbling, free from grease, water, ice, and have sufficient strength. It is recommended to perform an adhesion test using a section of profile of 200-300 mm. Spot application of the adhesive is NOT allowed.

Cutting profiles:

Thermal insulation profiles can be cut to different length with a

- circular or conventional saw
- jigsaw with an elongated blade and large teeth
- electric cutter for polystyrene
- knife

Conneting profiles

VSThermo thermal insulation profiles are equipped with locks for easy and quick installation. When joining the profiles, a strip of VST MS-15 adhesive sealant is applied to the end around the U-shaped lock. The lock itself also needs to be hermetically sealed. After that, the profiles are joined on the wall. Residues with a length of > 300 mm can be used in the future. The part of the profile on which the lock is mounted may only be used at the joints. It is not permitted to use the section with the lock at the beginning and end of any part of the window opening. Cut along the marking line applied to the profiles or to another required length, based on the calculation of the total height or width of the opening. It is recommended to calculate the required length of the profiles in advance according to the size of the window/door opening, taking into account that each profile segment should not be shorter than 300 mm.

Profile instalation

Apply adhesive to the mounting surface of the VSThermo profile with an "embroidered" pattern along the long edges of the profile. The adhesive strip should be without breaks, in two lines, at a distance of 15 mm from the edge of the profile. For convenience, you can follow the line formed by the pattern. Start the installation by installing the lower horizontal profile. After applying the adhesive, press the profile against the wall in the designated place to ensure even distribution of the adhesive. Align the profile horizontally using a spirit level or a laser level.

Fix the profile mechanically, using EJOT[®] Frame Anchor RA-Z-7.5. The length of the screw must be selected taking into account the material of the wall to which the VSThermo profile is attached. After installing the horizontal profile, install the vertical parts of the structure. Attention: The vertical profile must be supported by the horizontal profile along the entire cutting plane. Apply glue to the end surface adjacent to the horizontal profile and press the parts together to ensure a tight connection.

The method of gluing, levelling and mechanical fastening of the vertical parts is the same as for the horizontal profile. Additional profile supports must be installed under the lower horizontal profile using scraps or cutting them from the whole profile. The supports must be at least 150 mm long and no longer than 300 mm. The maximum permissible distance between adjacent supports is 600 mm. Installation of additional supports is performed similarly to the installation of vertical bars. The configuration of windows and doors must be taken into account when placing the supports.

Pre-wall installation

Pre-wall installation of windows and doors is allowed no earlier than 24 hours after installation of VSThermo 80x90 thermal insulation profiles. Installation of structures is carried out in accordance with Installation instructions RAL Gütegemeinschaft Fenster und Haustüren.

EJOT[®] Frame Anchor RA-Z-7.5 are used for fastening the window/door frame, which must be screwed to the maximum depth into the VSThermo profile material to ensure load distribution.

To seal the installation seam, it is recommended to use sealants: waterproofing vapour-permeable outer and waterproofing vapour barrier inner, or multifunctional tape, or window mounting tapes with appropriate characteristics.

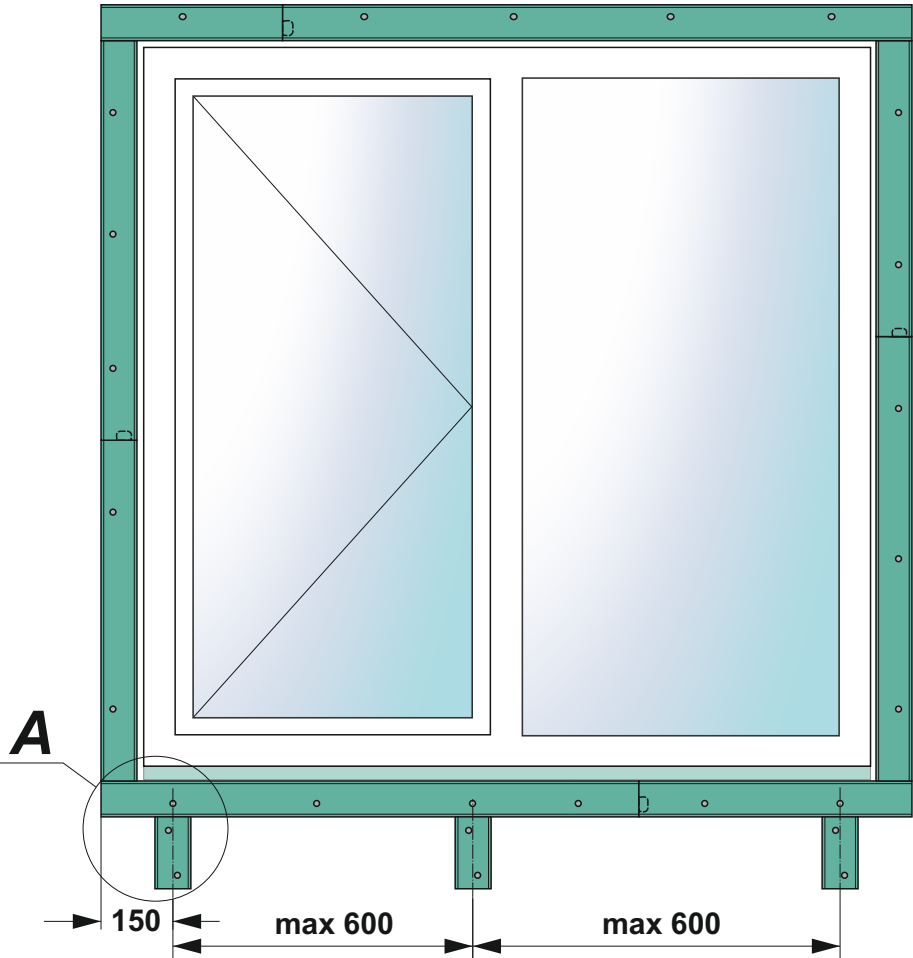
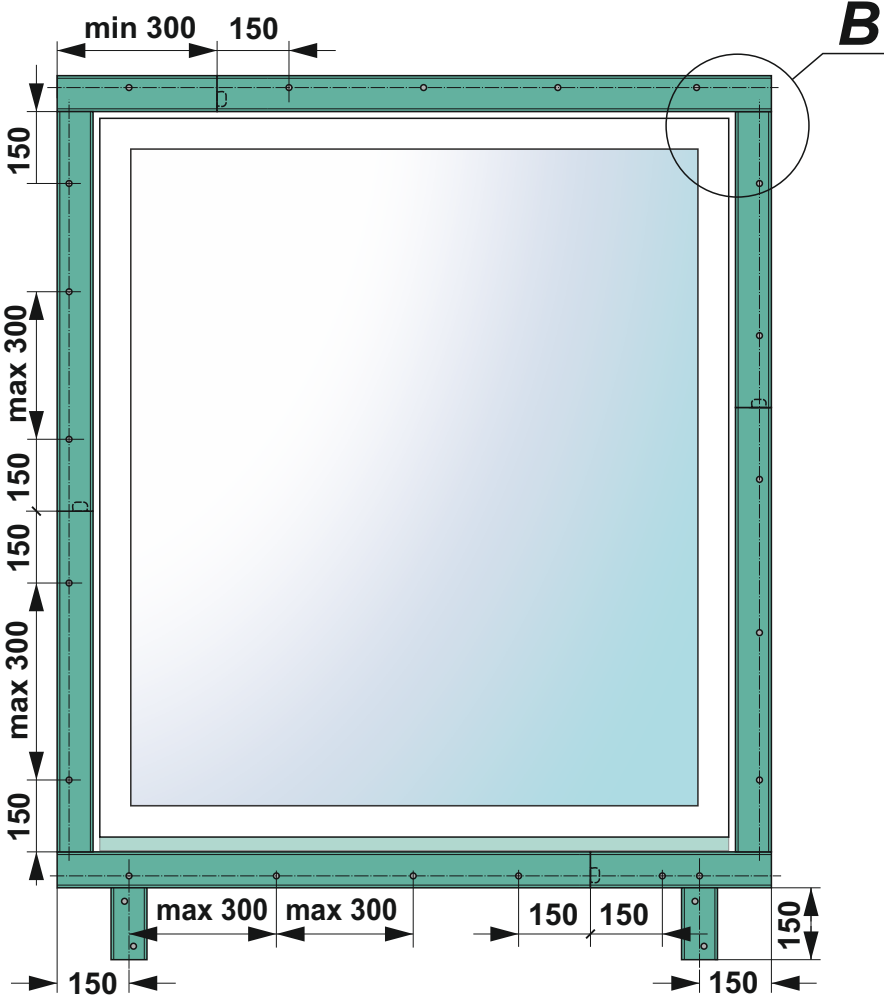

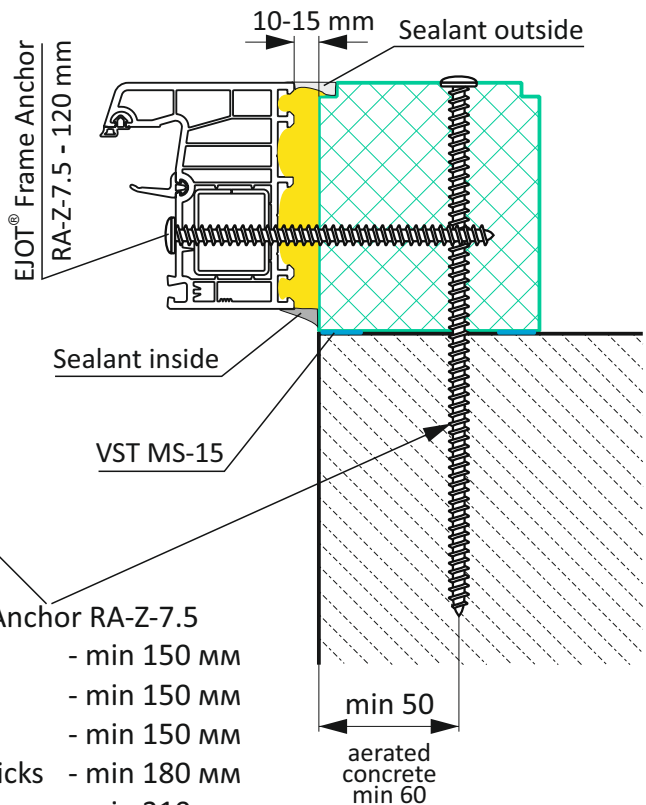
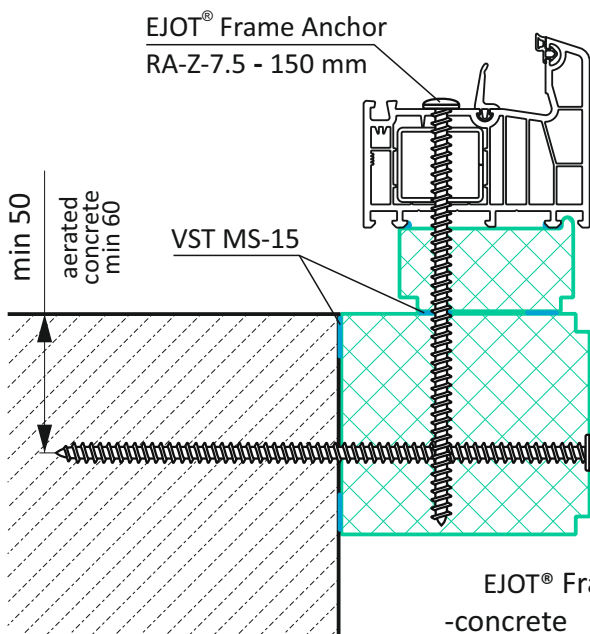
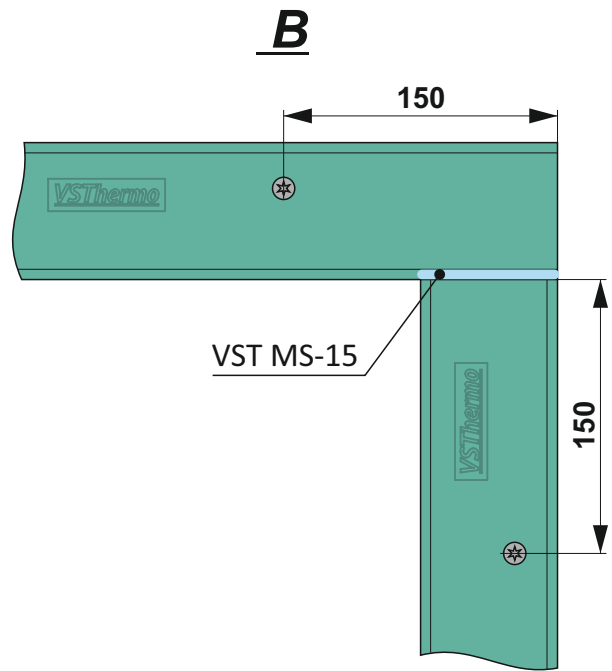
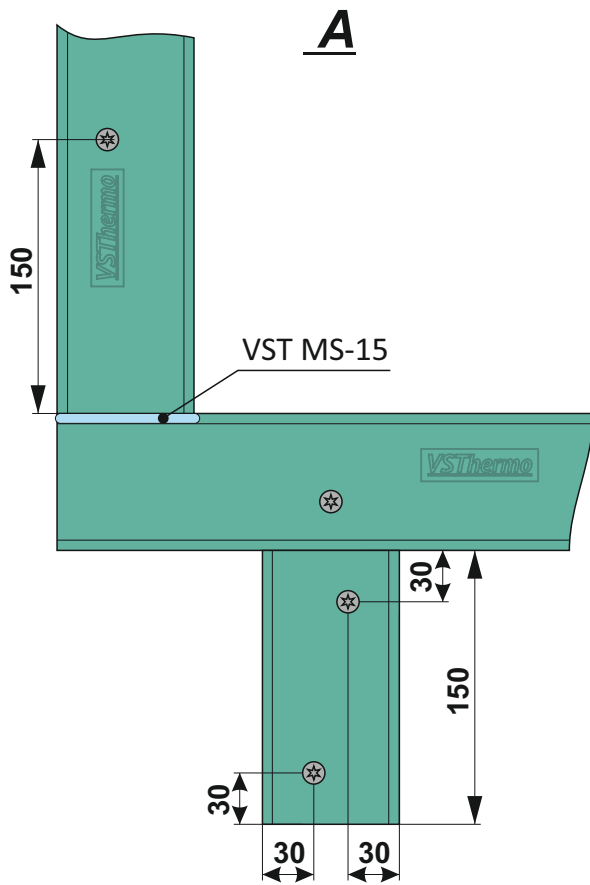

- EJOT® Frame Anchor RA-Z-7.5
- | | |
|-----------------------|--------------|
| -concrete | - min 150 mm |
| -silicate bricks | - min 150 mm |
| -wood | - min 150 mm |
| -solid ceramic bricks | - min 180 mm |
| -ceramic block | - min 210 mm |
| -aerated concrete | - min 210 mm |