

# CERTIFICATE

Certified Passive House Component

Component-ID 1589cw03 valid until 31st December 2025

Passive House Institute  
Dr. Wolfgang Feist  
64283 Darmstadt  
Germany

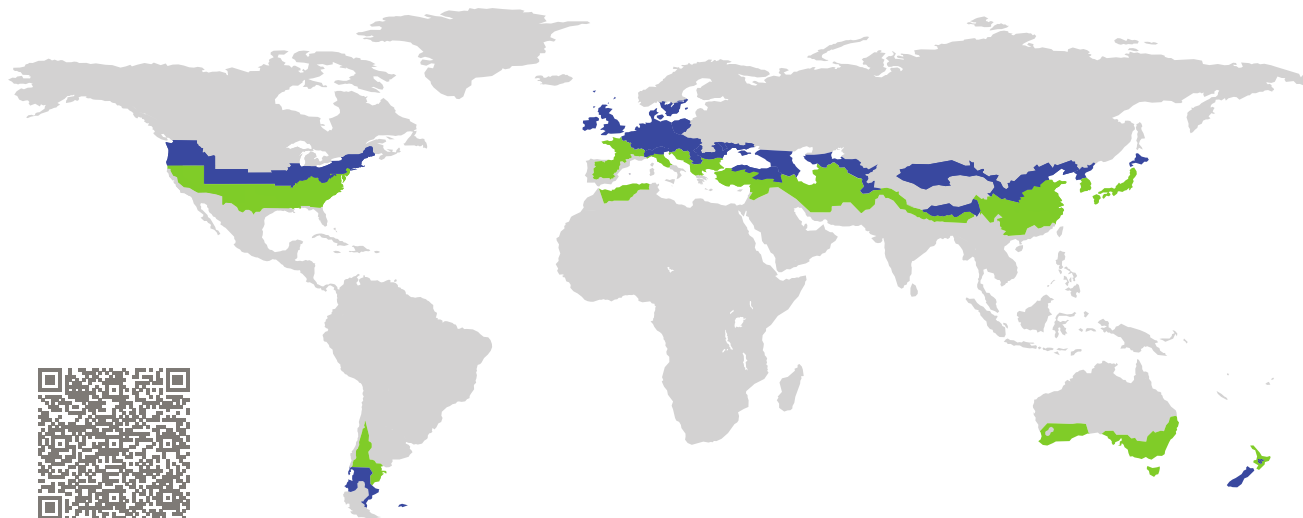

Category: **Curtain Wall**  
Manufacturer: **Jansen AG,  
Oberriet SG,  
Switzerland**  
Product name: **VISS HI (60 mm)**

**This certificate was awarded based on the following  
criteria for the cool, temperate climate zone**

Comfort  $U_{CW} = 0.80 \leq 0.80 \text{ W}/(\text{m}^2 \text{ K})$   
 $U_{CW, \text{installed}} \leq 0.85 \text{ W}/(\text{m}^2 \text{ K})$   
with  $U_g = 0.70 \text{ W}/(\text{m}^2 \text{ K})$

Hygiene  $f_{Rsi=0.25} \geq 0.70$

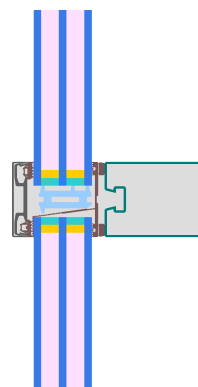

Passive House  
efficiency class

phE

phD

phC

phB

phA

cool, temperate climate



**CERTIFIED  
COMPONENT**

Passive House Institute

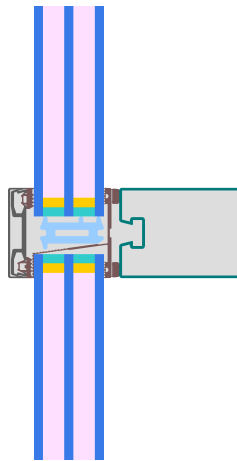

Calculation model

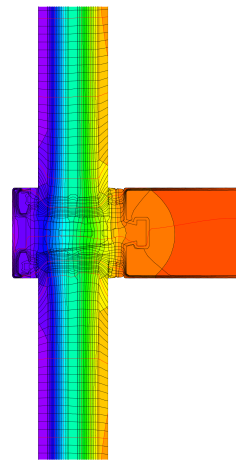

Isothermal

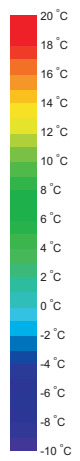

**Description**

Steel construction, Aluminium covering- and pressure-strip. PE-foam insulator in the glazing rebate (0,038 W/(mK)). Plastic glass-carrier on stainless steel bolts. Thermally insulated screws. Losses by screws and glass carrier were determined by 3d-thermal flux analysis (PHI). Used Pane: 46 mm (6/14/6/14/6), intersection of the Glass: 19/16 mm. Used spacer: SuperSpacer Premium with DOWSIL silicone secondary seal.

**Explanation**





The element U-values were calculated for the test element size of 1.20 m × 2.50 m with  $U_g = 0.70 \text{ W}/(\text{m}^2 \text{ K})$ . If a higher quality glazing is used, the element U-values will improve as follows:

Glazing	$U_g =$	0.70	0.69	0.58	0.53	$\text{W}/(\text{m}^2 \text{ K})$
		↓	↓	↓	↓	
Element	$U_{CW}$	0.80	0.79	0.69	0.64	$\text{W}/(\text{m}^2 \text{ K})$

Transparent building components are sorted into efficiency classes depending on the heat losses through the opaque part. The frame U-Values, frame widths, thermal bridges at the glazing edge and the glazing edge lengths are included in these heat losses. A more detailed report of the calculations performed in the context of certification is available from the manufacturer.

The Passive House Institute has defined international component criteria for seven climate zones. In principle, components that have been certified for climate zones with higher thermal requirements may also be used in climates with less stringent requirements. In a particular climate zone it may make sense to use a component of a higher thermal quality which has been certified for a climate zone with more stringent requirements.

Further information relating to certification can be found on [www.passivehouse.com](http://www.passivehouse.com) and [passipedia.org](http://passipedia.org).

Frame values			Frame width $b_f$ mm	$U$ -value frame $U_f$ <sup>1</sup> W/(m <sup>2</sup> K)	$\Psi$ -glazing edge $\Psi_g$ W/(m K)	Temp. Factor $f_{Rsi=0.25}$ [-]
Mullion fixed	(OM1)		60	0.82	0.036	0.79
Transom fixed	(OT1)		60	0.92	0.035	0.77
Bottom fixed	(FB1)		60	0.93	0.034	0.78
Top fixed	(FH1)		60	0.93	0.034	0.78
Lateral fixed	(FJ1)		60	0.84	0.035	0.78
Spacer: Super Spacer® Premium			Secondary seal: DOWSIL™ 3364 Warm Edge IG Sealant			

Thermal glass carrier bridge<sup>2</sup>  $\chi_{GT} = 0.008$  W/K

### Validated installations

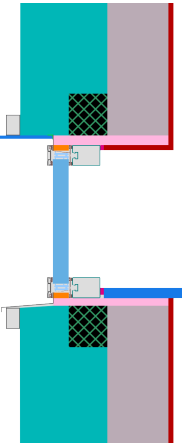
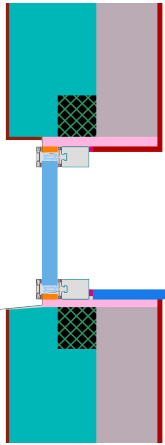
Ventilated facade (fixed glazing)		Exterior insulation and finishing system (EIFS) (fixed glazed)	
$U_{Wall} = 0.13$ W/(m <sup>2</sup> K)		$U_{Wall} = 0.13$ W/(m <sup>2</sup> K)	
			
$\Psi_{install}$	W/(m K)	$\Psi_{install}$	W/(m K)
Top	0.024	Top	0.024
Left	0.021	Left	0.021
Right	0.021	Right	0.021
Bottom	0.023	Bottom	0.023
$U_{W,installed} = 0.83$ W/(m <sup>2</sup> K)		$U_{W,installed} = 0.83$ W/(m <sup>2</sup> K)	

<sup>1</sup> Includes  $\Delta U = 0.12$  W/(m<sup>2</sup> K). Determined through 3D FEM simulation

<sup>2</sup> Determined through 3D FEM simulation. Glass carrier type: Non-metallic glass carrier with screws

