

# CERTIFICATE

Certified Passive House Component

Component-ID 2297rs04 valid until 31st December 2025

Passive House Institute  
Dr. Wolfgang Feist  
64283 Darmstadt  
Germany

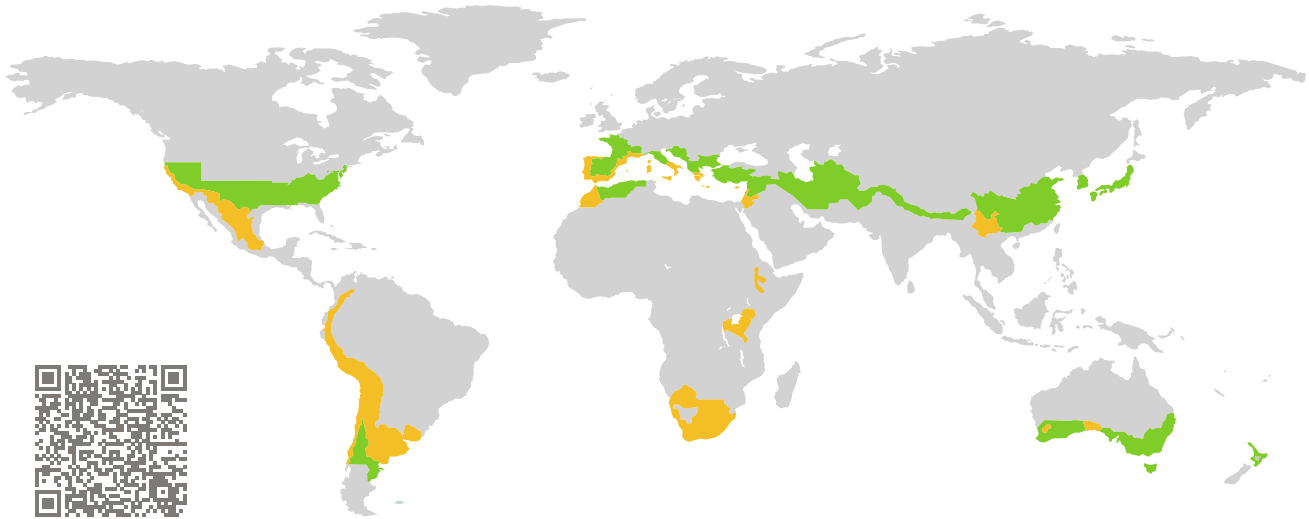

Category: **Sun protection (Roller shutter)**

Manufacturer: **PERFILES PLECK, S.A.L.,  
Benissa, Alicante,  
Spain**

Product name: **PREMIUM 200  
PREMIUM 200 PLUS**

**This certificate was awarded based on the following  
criteria for the warm, temperate climate zone**

Efficiency:  $\Delta U \leq 0.16 \text{ W}/(\text{m}^2\text{K})$

Hygiene:  $f_{Rsi=0.25} \geq 0.65$

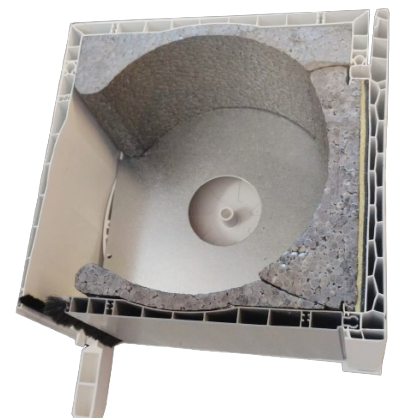

warm, temperate climate



**CERTIFIED  
COMPONENT**

Passive House Institute

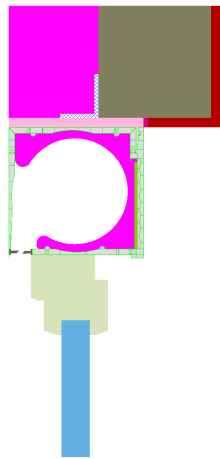

Calculation model



Isothermal

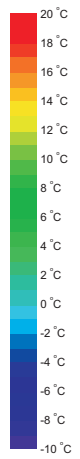



**Description**

PVC Roller shutter box with EPS (0.032 W/(mK)) thermal insulation. Soundproofing membrane 3.9 mm thick in PREMIUM 200 PLUS model. Casing height: 200 mm, maximum shading length 2500 mm including the roller shutter box. PHI standard frame representing a wooden or vinyl frame. Conductivity: 0.113 W/(mK). Depth: 100 mm. Pane thickness: 44 mm (4/16/4/16/4). Rebate depth: 23mm. Spacer: PHI class phB with polysulfide as secondary seal.

The Passive House Institute has defined international component criteria for seven climate zones. In principle, components which have been certified for climate zones with higher requirements may also be used in climates with less stringent requirements. In a particular climate zone it may make sense to use a component of a higher thermal quality which has been certified for a climate zone with more stringent requirements.

Further information relating to certification can be found on [www.passivehouse.com](http://www.passivehouse.com) and [passipedia.org](http://passipedia.org).

Frame values		Frame width $b_f$ mm	$U$ -value frame $U_f$ W/(m <sup>2</sup> · K)	$\Psi$ -glazing edge $\Psi_g$ W/(m · K)	Temp. Factor $f_{RSI=0.25}$ [-]
Bottom	(OB1) 	125	0.92	0.038	0.67
Top	(OH1) 	125	0.92	0.038	0.67
Side	(OJ1) 	125	0.92	0.038	0.67
Spacer: PHI phB-Spacer			Secondary seal: Polysulfide		

## Validated installations

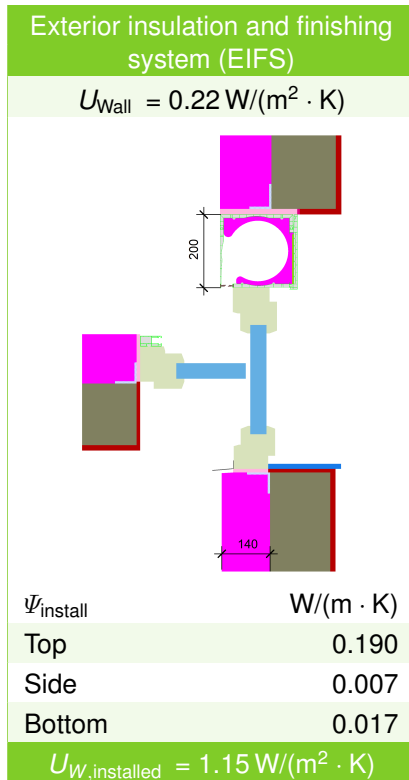

Window size: 1.23 m x 1.48 m

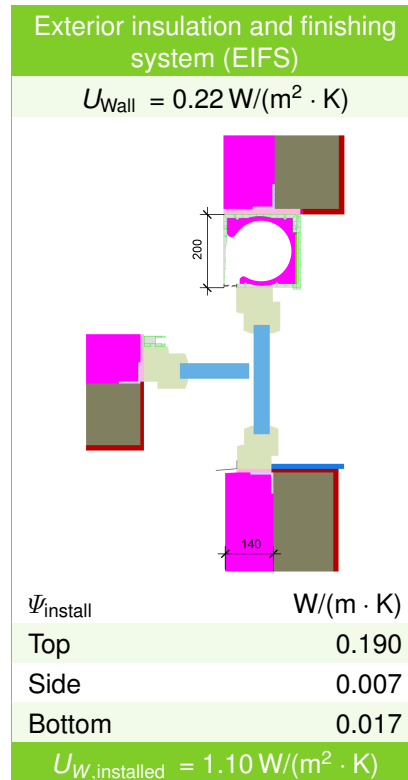

Window size: 1.1 m x 2.2 m

