

证书

被动房已认证组件

组件认证编码 2063wi03 有效至 31st December 2025

Passive House Institute
Dr. Wolfgang Feist
64283 Darmstadt
Germany

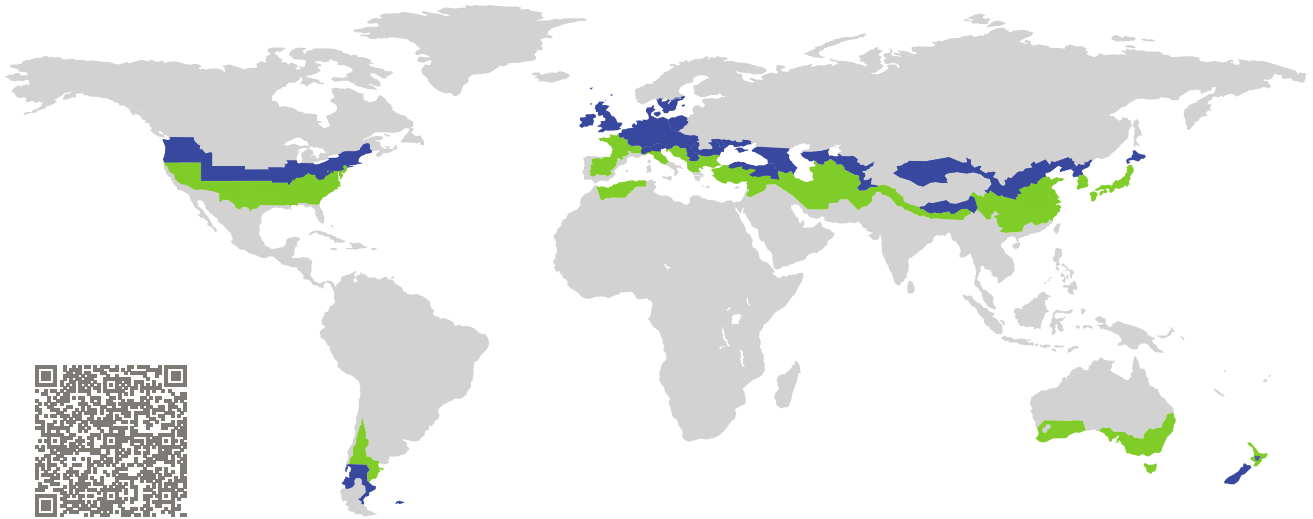

类别: 窗框
制造商: **Guangdong Sightsengroup Energy Conservation Technology Co., LTD, Zhaoqing, China**
产品名称: **XMG ES95**

此证书根据以下规格颁发, 适用于凉温气候带 (**cool temperate**)

舒适度 $U_W = 0.80 \leq 0.80 \text{ W}/(\text{m}^2 \text{ K})$
 $U_{W, \text{installed}} \leq 0.85 \text{ W}/(\text{m}^2 \text{ K})$
with $U_g = 0.70 \text{ W}/(\text{m}^2 \text{ K})$

卫生标准 $f_{Rsi=0.25} \geq 0.70$

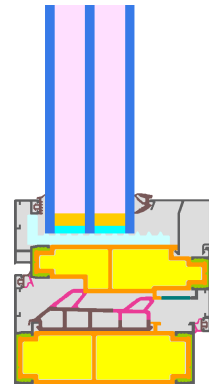

被动房
节能等级

phE

phD

phC

phB

phA

cool, temperate climate



**CERTIFIED
COMPONENT**

Passive House Institute

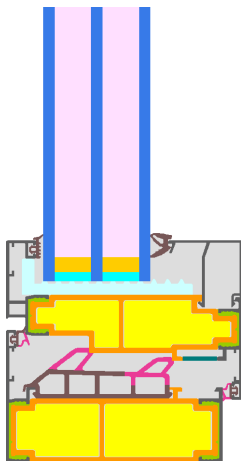

计算模型

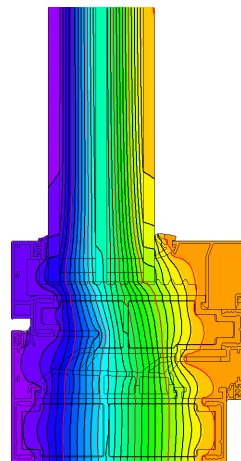

等温线图

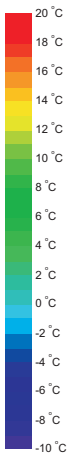

认证产品描述

Aluminum frame with low-lambda-PA separation (0.22 W/(mK)) and resol resin foam insulation (0.025 W/(mK)) in the cavities. Polyethylene foam insulation (0.038 W/(mK)) in the glazing rebate. Pane thickness: 47 mm (5/16/5/16/5), rebate depth: 17 mm.

说明

整窗U值是基于参照尺寸 1.23 m × 1.48 m with $U_g = 0.70 \text{ W}/(\text{m}^2 \text{ K})$. 若使用更高品质的节能玻璃，整窗U值可提升如下：

玻璃	$U_g =$	0.70	0.64	0.58	0.54	W/(m ² K)
		↓	↓	↓	↓	
整窗	$U_w =$	0.80	0.75	0.71	0.68	W/(m ² K)

建筑透明组件通过非透明部份的传热损失进行节能分级。整窗传热损失包括由窗框U值和窗框宽度，暖边热桥和暖边长度引起的热损失。详细计算可从制造商获取。

被动房研究所将国际组件认证标准划分为七种气候类型。原则上，满足更高节能要求的认证组件也可用于节能要求较低的气候区。在特定气候区中，使用具有高节能要求的认证组件会更具有意义。

更多认证信息: www.passivehouse.com and passipedia.org.

安装节点

Ventilated facade		外保温及饰面系统(EIFS) (开启扇)		空心墙(可活动式)	
$U_{\text{墙}} = 0.13 \text{ W}/(\text{m}^2 \text{ K})$		$U_{\text{墙}} = 0.13 \text{ W}/(\text{m}^2 \text{ K})$		$U_{\text{墙}} = 0.13 \text{ W}/(\text{m}^2 \text{ K})$	
<p>Ventilated facade – substructure Mineral wool 0.035 W/(mK) Concrete 2.3 W/(mK) Interior plaster 0.57 W/(mK)</p>		<p>Exterior plaster 1.0 W/(mK) EPS 0.035 W/(mK) Adhesive 0.70 W/(mK) Sand-lime brick 1.0 W/(mK) Interior plaster 0.57 W/(mK)</p>		<p>Clinker Brick 1.2 W/(mK) Air gap EPS 0.035 W/(mK) Sand-lime brick 1.0 W/(mK) Interior plaster 0.57 W/(mK)</p>	
<p>Suitable fastening, e.g. mounting frame or bracket, but only protruding as far as necessary for fixing the window</p>		<p>Suitable fastening, e.g. mounting frame or bracket, but only protruding as far as necessary for fixing the window</p>		<p>Suitable fastening, e.g. mounting frame or bracket, but only protruding as far as necessary for fixing the window</p>	
$\Psi_{\text{安装}}$	W/(m K)	$\Psi_{\text{安装}}$	W/(m K)	$\Psi_{\text{安装}}$	W/(m K)
上口	0.018	上口	0.017	上口	0.016
侧边	0.018	侧边	0.017	侧边	0.016
下口	0.023	下口	0.023	下口	0.023
$U_{W, \text{已安装}} = 0.85 \text{ W}/(\text{m}^2 \text{ K})$		$U_{W, \text{已安装}} = 0.85 \text{ W}/(\text{m}^2 \text{ K})$		$U_{W, \text{已安装}} = 0.85 \text{ W}/(\text{m}^2 \text{ K})$	

窗框参数		宽度	U-值	暖边热桥- Ψ -值	温度系数 (卫生标准)
		b_f mm	U_f W/(m ² K)	Ψ_g W/(m K)	$f_{Rsi=0.25}$ [-]
立柱1	(1M1)	118	0.86	0.025	0.76
下横框	(OB1)	98	0.82	0.025	0.76
上横框	(OH1)	98	0.82	0.025	0.76
侧面	(OJ1)	98	0.82	0.025	0.76
暖边间隔条: Technoform-Spacer SP16			双层密封胶: Butyl		

