

CERTIFICATE

Certified Passive House Component

Component-ID 1822wi03 valid until 31st December 2025

Passive House Institute
Dr. Wolfgang Feist
64283 Darmstadt
Germany

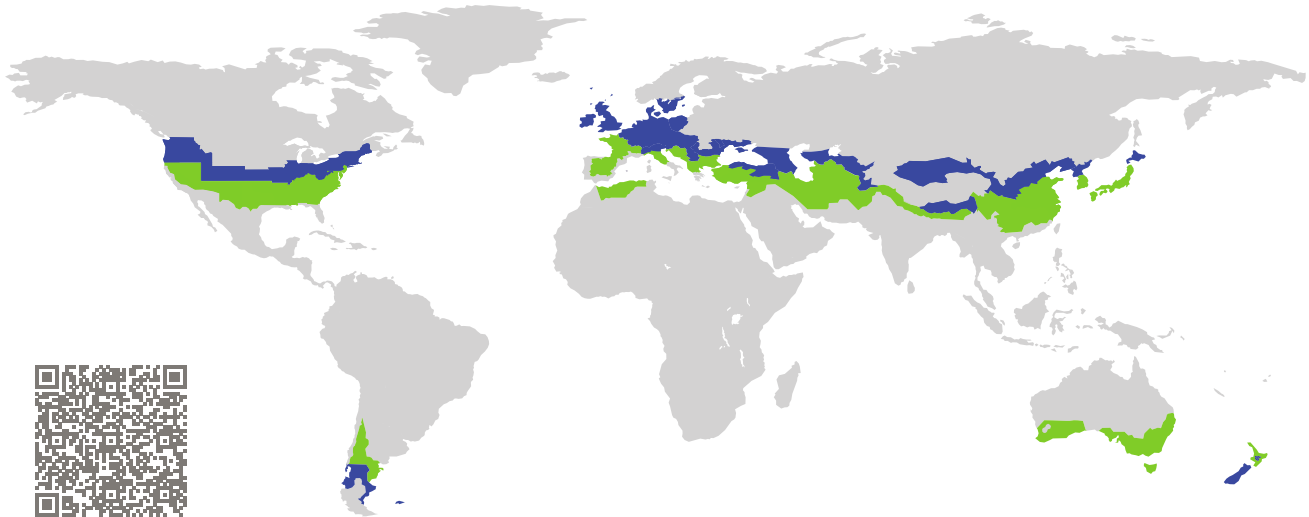

Category: **Window Frame**
Manufacturer: **REYNAERS ALUMINIUM NV/SA,
Duffel,
Belgium**
Product name: **MasterLine 10**

**This certificate was awarded based on the following
criteria for the cool, temperate climate zone**

Comfort $U_W = 0.80 \leq 0.80 \text{ W}/(\text{m}^2 \text{ K})$
 $U_{W, \text{installed}} \leq 0.85 \text{ W}/(\text{m}^2 \text{ K})$
with $U_g = 0.70 \text{ W}/(\text{m}^2 \text{ K})$

Hygiene $f_{Rsi=0.25} \geq 0.70$

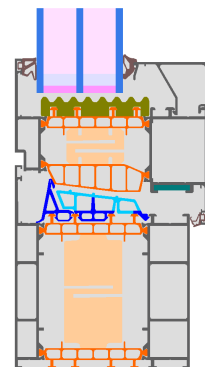

Passive House
efficiency class

phE

phD

phC

phB

phA

www.passivehouse.com

cool, temperate climate



**CERTIFIED
COMPONENT**

Passive House Institute

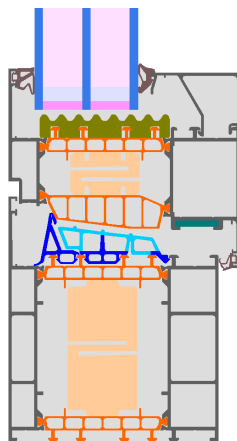

Calculation model



Isothermal

Description

Aluminium frame with thermal separation (low lambda PA 0.21 W/(mK)), XPS foam insulation (0.029 W/(mK)) and insulation (0.038 W/(mK)) in the rebate; Pane thickness: 48 mm (4/18/4/18/4), rebate depth: 18 mm

Explanation

The window U-values were calculated for the test window size of 1.23 m × 1.48 m with $U_g = 0.70$ W/(m² K). If a higher quality glazing is used, the window U-values will improve as follows:

Glazing	$U_g =$	0.70	0.64	0.58	0.52	W/(m ² K)
		↓	↓	↓	↓	
Window	$U_W =$	0.80	0.77	0.74	0.70	W/(m ² K)





Transparent building components are classified into efficiency classes depending on the heat losses through the opaque part. The frame U-Values, frame widths, thermal bridges at the glazing edge, and the glazing edge lengths are included in these heat losses. A more detailed report of the calculations performed in the context of certification is available from the manufacturer.

The Passive House Institute has defined international component criteria for seven climate zones. In principle, components which have been certified for climate zones with higher requirements may also be used in climates with less stringent requirements. In a particular climate zone it may make sense to use a component of a higher thermal quality which has been certified for a climate zone with more stringent requirements.

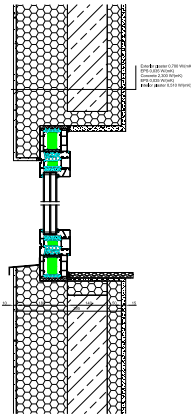
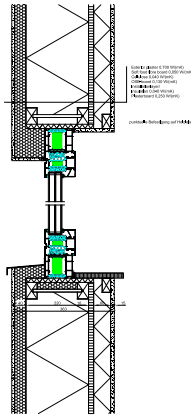
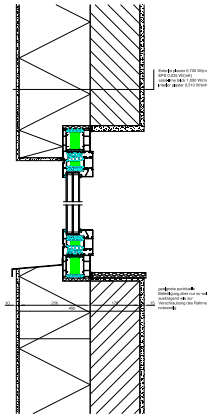
Further information relating to certification can be found on www.passivehouse.com and passipedia.org.

Validated installations

Formwork blocks (operable)		Lightweight timber (operable)		Exterior insulation and finishing system (EIFS) (operable)	
$U_{\text{Wall}} = 0.15 \text{ W}/(\text{m}^2 \text{ K})$		$U_{\text{Wall}} = 0.13 \text{ W}/(\text{m}^2 \text{ K})$		$U_{\text{Wall}} = 0.13 \text{ W}/(\text{m}^2 \text{ K})$	
					
Ψ_{install}	W/(m K)	Ψ_{install}	W/(m K)	Ψ_{install}	W/(m K)
Top	0.004	Top	0.009	Top	0.005
Side	0.004	Side	0.009	Side	0.005
Bottom	0.015	Bottom	0.020	Bottom	0.018
$U_{W,\text{installed}} = 0.82 \text{ W}/(\text{m}^2 \text{ K})$		$U_{W,\text{installed}} = 0.84 \text{ W}/(\text{m}^2 \text{ K})$		$U_{W,\text{installed}} = 0.83 \text{ W}/(\text{m}^2 \text{ K})$	

Frame values		Frame width	U -value frame	Ψ -glazing edge	Temp. Factor	
		b_f	U_f	Ψ_g	$f_{Rsi=0.25}$	
		mm	W/(m ² K)	W/(m K)	[-]	
Mullion	(1M1)		186	0.79	0.030	0.78
Bottom	(OB1)		172	0.78	0.030	0.78
Top	(OH1)		172	0.78	0.030	0.78
Lateral	(OJ1)		172	0.78	0.030	0.78
Spacer: SWISSPACER Ultimate			Secondary seal: Polysulfide			

