

# CERTIFICATE

Certified Passive House Component

Component-ID 2257wm03 valid until 31st December 2025

Passive House Institute  
Dr. Wolfgang Feist  
64283 Darmstadt  
Germany

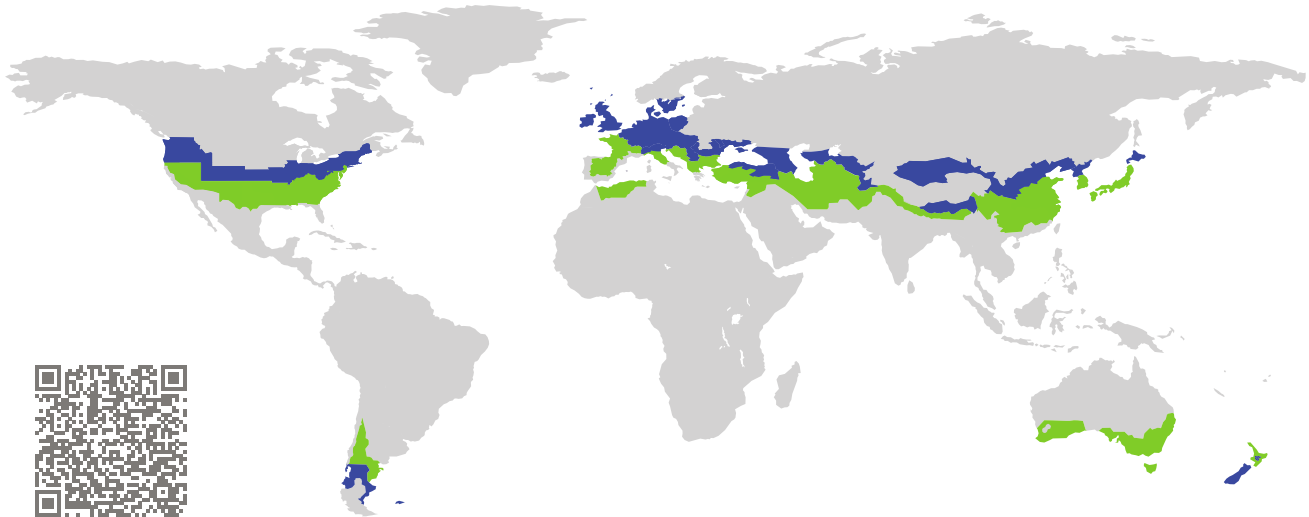

Category: **Window mounting system**

Manufacturer: **LLC «OLIS»,  
Kyiv,  
Ukraine**

Product name: **VSThermo VST 80x90**

**This certificate was awarded based on the following  
criteria for the cool, temperate climate zone**

Efficiency  $\Delta U \leq 0.05 \text{ W}/(\text{m}^2 \cdot \text{K})$

Hygiene  $f_{\text{Rsi} = 0.25} \geq 0.70$



cool, temperate climate



**CERTIFIED  
COMPONENT**

Passive House Institute

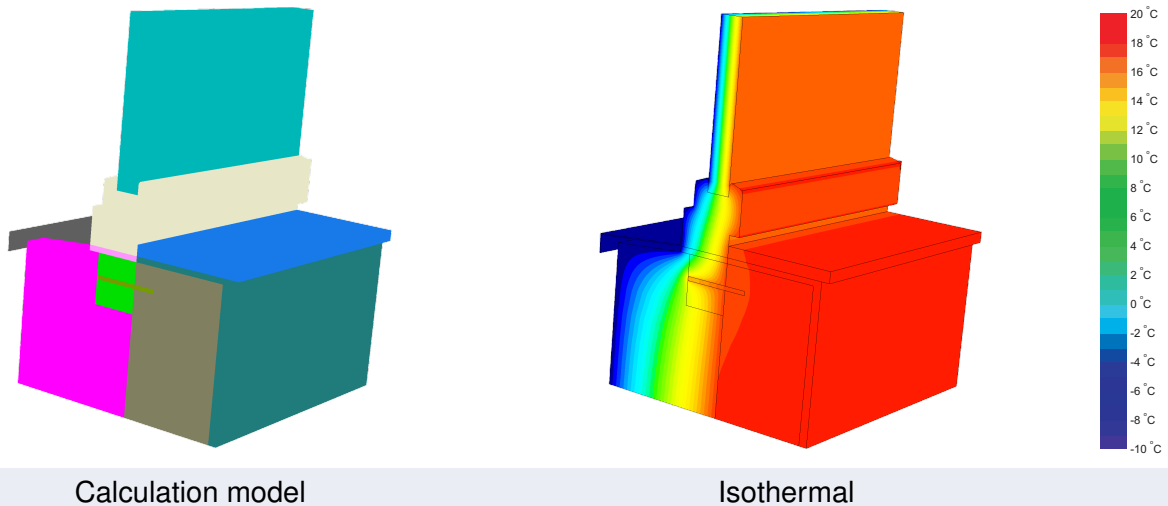

Calculation model

Isothermal

## Description

Pre-wall mounting system from dense EPS foam [0.040 W/(m.K)], 80×90 mm. Assembly by glueing and screwing. Additional thermal losses by screws determined by 3D heat flux simulation. Losses are included in the conductivity of the EPS-foam.

## Explanation

The certifiability is demonstrated by the increase of the heat transfer coefficient  $\Delta U$  [W/(m<sup>2</sup>.K)] caused by the installation thermal bridge (efficiency criterion) in conjunction with given installation situations and window frames as well as by the minimum temperature factor at the coldest point of the installation connection (hygiene criterion).

The heat transfer coefficients (U-values) and the thermal bridge loss coefficients ( $\psi$ -values) of the window are determined on the basis of DIN EN ISO 10077-2, the installation thermal bridges according to ISO 10211.



The Passive House Institute has defined international component criteria for seven climate zones. In principle, components which have been certified for climate zones with higher requirements may also be used in climates with less stringent requirements. In a particular climate zone it may make sense to use a component of a higher thermal quality which has been certified for a climate zone with more stringent requirements.

Further information relating to certification

can be found on [www.passivehouse.com](http://www.passivehouse.com) and [passipedia.org](http://passipedia.org).

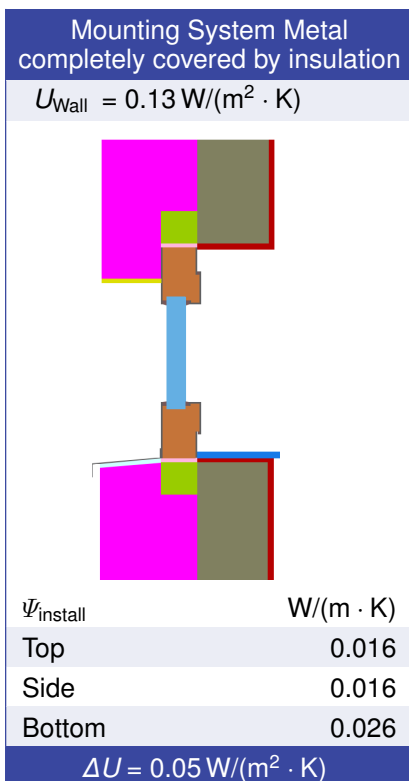
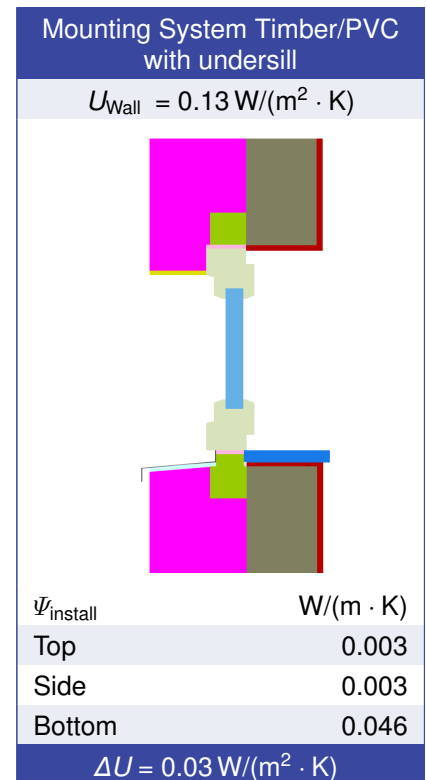
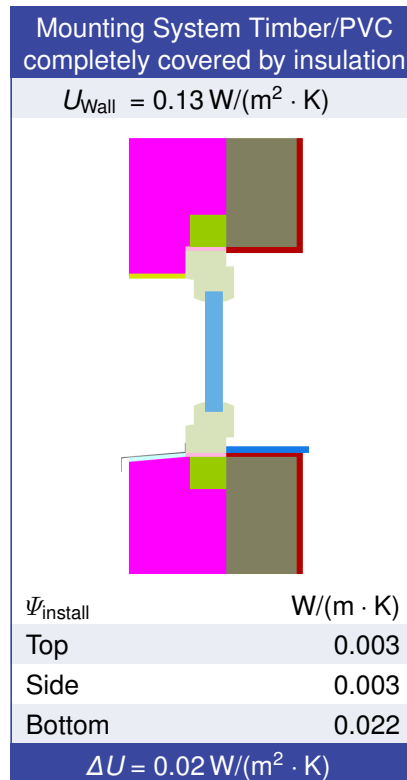
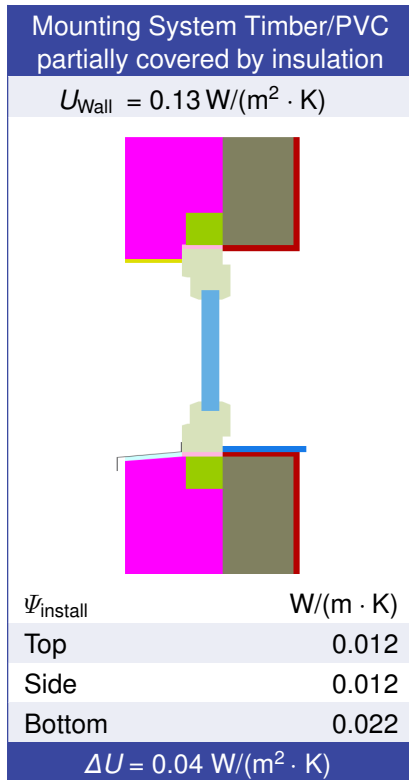
## Validated installations



Frame values		Frame width $b_f$ mm	$U$ -value frame $U_f$ W/(m <sup>2</sup> · K)	$\Psi$ -glazing edge $\Psi_g$ W/(m · K)	Temp. Factor $f_{Rsi=0.25}$ [-]
Bottom	(OB1) 	125	0.73	0.036	0.73
Top	(OH1) 	125	0.73	0.036	0.73
Lateral	(OJ1) 	125	0.73	0.036	0.73
Spacer: PHI phB-Spacer			Secondary seal: Polysulfide		

