

# CERTIFICATE

Certified Passive House Component

Component-ID 1149wi04 valid until 31st December 2025

Passive House Institute  
Dr. Wolfgang Feist  
64283 Darmstadt  
Germany

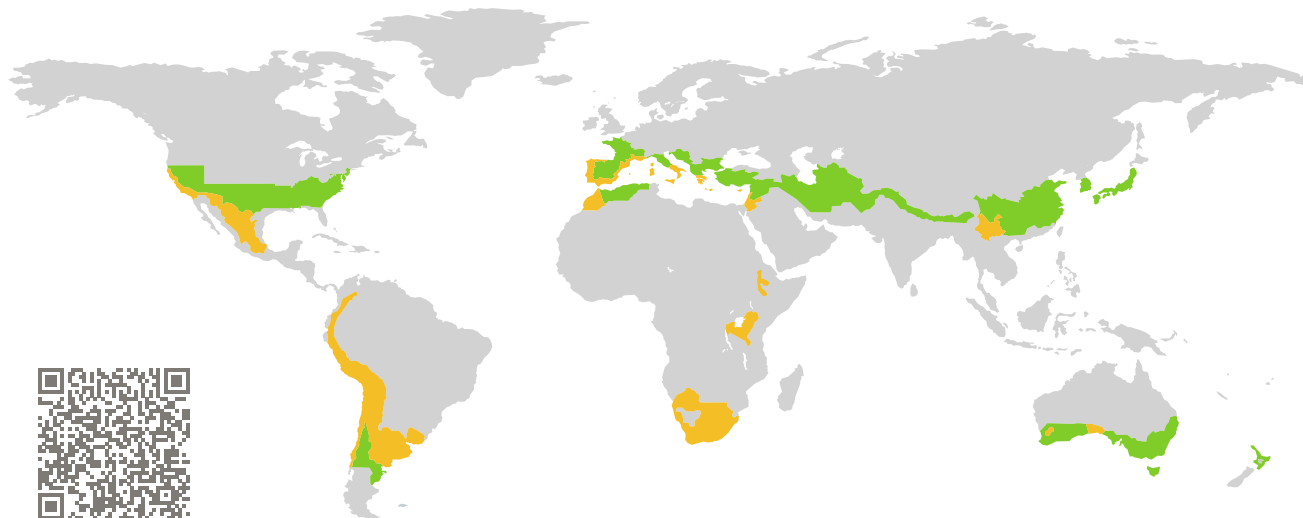

Category: **Window Frame**  
Manufacturer: **Alumil S.A.,  
Efkarpi Thessaloniki,  
Greece**  
Product name: **S77 Passive**

**This certificate was awarded based on the following  
criteria for the warm, temperate climate zone**

Comfort  $U_{W=1.00} \leq 1.00 \text{ W}/(\text{m}^2 \text{ K})$   
 $U_{W,\text{installed}} \leq 1.05 \text{ W}/(\text{m}^2 \text{ K})$   
with  $U_g = 0.90 \text{ W}/(\text{m}^2 \text{ K})$

Hygiene  $f_{Rsi=0.25} \geq 0.65$

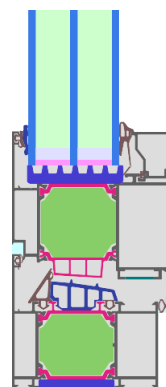

Passive House  
efficiency class

phE

phD

phC

phB

phA

[www.passivehouse.com](http://www.passivehouse.com)

warm, temperate climate



phC



**CERTIFIED  
COMPONENT**

Passive House Institute

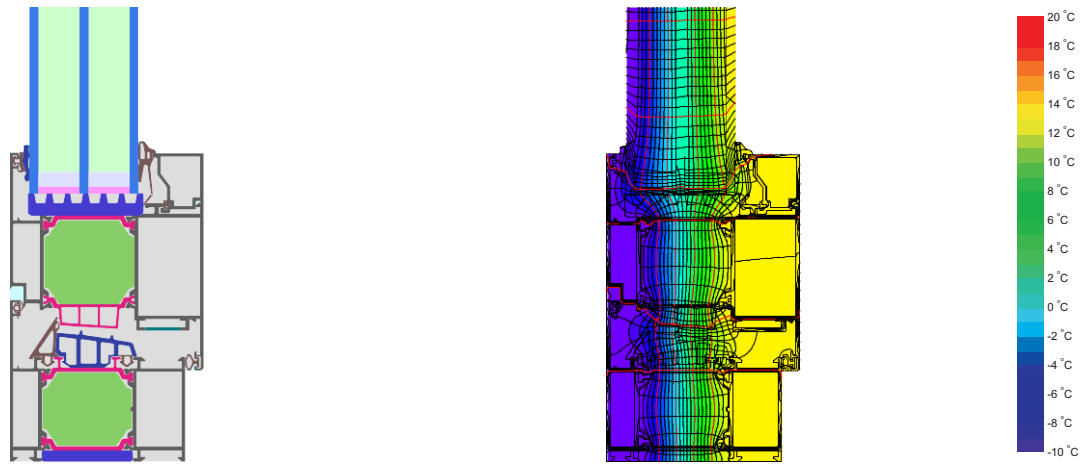

Calculation model

Isothermal

### Description

Thermally separated aluminium frame with low thermal conductivity polyamide (25% glass fibre) and KOOLTHERM Q3 insulation bars (0,021 W/(mK)), Polyethylene rebate insulation foam (0,05 W/(mK)). Pane thickness: 48 mm (4/18/4/18/4), rebate depth: 18mm, spacer: SWISSPACER Ultimate with polysulfide secondary seal.

### Explanation

The window U-values were calculated for the test window size of 1.23 m × 1.48 m with  $U_g = 0.90 \text{ W}/(\text{m}^2 \text{ K})$ . If a higher quality glazing is used, the window U-values will improve as follows:

Glazing	$U_g =$	0.90	0.80	0.70	0.64	W/(m <sup>2</sup> K)
		↓	↓	↓	↓	
Window	$U_W =$	1.00	0.94	0.87	0.84	W/(m <sup>2</sup> K)

Transparent building components are classified into efficiency classes depending on the heat losses through the opaque part. The frame U-Values, frame widths, thermal bridges at the glazing edge, and the glazing edge lengths are included in these heat losses. A more detailed report of the calculations performed in the context of certification is available from the manufacturer.

The Passive House Institute has defined international component criteria for seven climate zones. In principle, components which have been certified for climate zones with higher requirements may also be used in climates with less stringent requirements. In a particular climate zone it may make sense to use a component of a higher thermal quality which has been certified for a climate zone with more stringent requirements.

Further information relating to certification can be found on [www.passivehouse.com](http://www.passivehouse.com) and [passipedia.org](http://passipedia.org).

## Validated installations

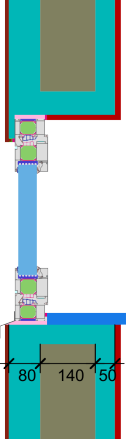
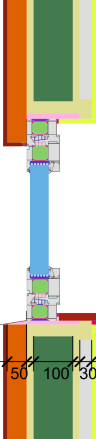
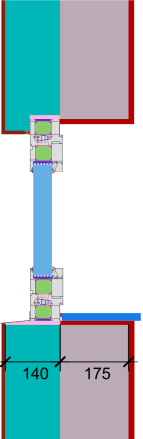
Formwork blocks (operable)	Lightweight timber (operable)	Exterior insulation and finishing system (EIFS) (operable)
$U_{\text{Wall}} = 0.25 \text{ W}/(\text{m}^2 \text{ K})$	$U_{\text{Wall}} = 0.24 \text{ W}/(\text{m}^2 \text{ K})$	$U_{\text{Wall}} = 0.23 \text{ W}/(\text{m}^2 \text{ K})$
		
$\Psi_{\text{install}}$ W/(m K)	$\Psi_{\text{install}}$ W/(m K)	$\Psi_{\text{install}}$ W/(m K)
Top 0.014	Top 0.012	Top 0.012
Side 0.014	Side 0.012	Side 0.012
Bottom 0.022	Bottom 0.023	Bottom 0.016
$U_{W,\text{installed}} = 1.05 \text{ W}/(\text{m}^2 \text{ K})$	$U_{W,\text{installed}} = 1.04 \text{ W}/(\text{m}^2 \text{ K})$	$U_{W,\text{installed}} = 1.04 \text{ W}/(\text{m}^2 \text{ K})$

Frame values		Frame width $b_f$ mm	$U$ -value frame $U_f$ W/(m <sup>2</sup> K)	$\Psi$ -glazing edge $\Psi_g$ W/(m K)	Temp. Factor $f_{Rsi=0.25}$ [-]
Flying Mullion (FM1)		161	1.00	0.025	0.73
Bottom (OB1)		136	1.02	0.024	0.74
Top (OH1)		136	1.02	0.024	0.74
Lateral (OJ1)		136	1.02	0.024	0.74
		Spacer: SWISSPACER Ultimate		Secondary seal: Polysulfide	

