

CERTIFICATE

Certified Passive House Component

Component-ID 1945cw03 valid until 31st December 2025

Passive House Institute
Dr. Wolfgang Feist
64283 Darmstadt
Germany

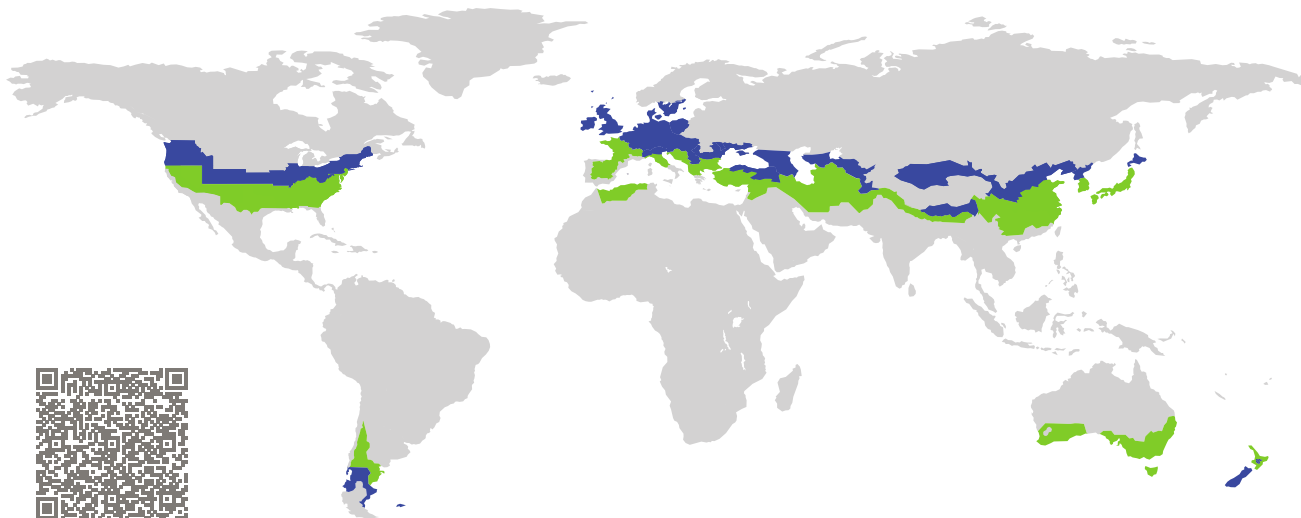

Category: **Curtain Wall**
Manufacturer: **REYNAERS ALUMINIUM NV/SA,
Duffel,
Belgium**
Product name: **ConceptWall 60 High Insulation**

**This certificate was awarded based on the following
criteria for the cool, temperate climate zone**

Comfort $U_{CW} = 0.80 \leq 0.80 \text{ W}/(\text{m}^2 \text{ K})$
 $U_{CW, \text{installed}} \leq 0.85 \text{ W}/(\text{m}^2 \text{ K})$
with $U_g = 0.70 \text{ W}/(\text{m}^2 \text{ K})$

Hygiene $f_{Rsi=0.25} \geq 0.70$

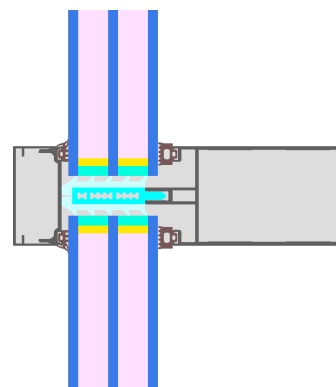

Passive House
efficiency class

phE

phD

phC

phB

phA

cool, temperate climate



**CERTIFIED
COMPONENT**

Passive House Institute

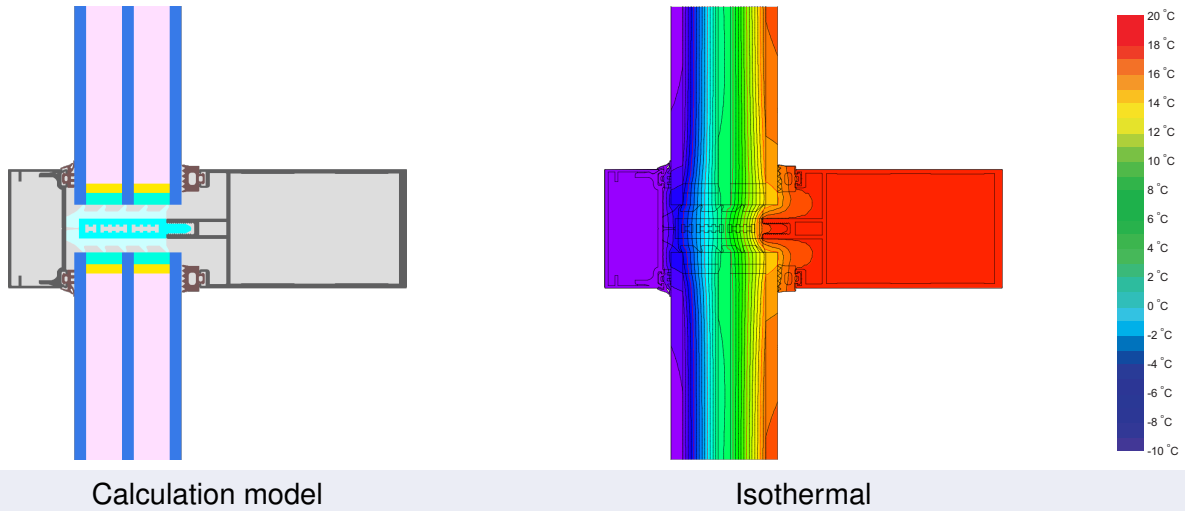

Description

Aluminium stick curtain wall 60 mm wide, insulation by PE/PET-foam (0.038/0.035 W/mK). Glass thickness 54 mm (6/18/6/18/6) with 18 mm insertion and Edgetech Super Spacer Premium with butyl secondary seal. Non-metallic glass carrier with screws - standard supplementary ChiGT-value of 0,004 W/K applied. Stainless steel pressure plate screws at 300 mm centres - standard supplementary Delta-U-value of 0,30 W/(m²K) applied.

Explanation





The element U-values were calculated for the test element size of 1.20 m × 2.50 m with $U_g = 0.70 \text{ W}/(\text{m}^2 \text{ K})$. If a higher quality glazing is used, the element U-values will improve as follows:

Glazing	$U_g =$	0.70	0.63	0.58	0.52	W/(m² K)
		↓	↓	↓	↓	
Element	U_{CW}	0.80	0.73	0.69	0.63	W/(m² K)

Transparent building components are sorted into efficiency classes depending on the heat losses through the opaque part. The frame U-Values, frame widths, thermal bridges at the glazing edge and the glazing edge lengths are included in these heat losses. A more detailed report of the calculations performed in the context of certification is available from the manufacturer.

The Passive House Institute has defined international component criteria for seven climate zones. In principle, components that have been certified for climate zones with higher thermal requirements may also be used in climates with less stringent requirements. In a particular climate zone it may make sense to use a component of a higher thermal quality which has been certified for a climate zone with more stringent requirements.

Further information relating to certification can be found on www.passivehouse.com and passipedia.org.

Frame values			Frame width b_f mm	U -value frame U_f^1 W/(m ² K)	Ψ -glazing edge Ψ_g W/(m K)	Temp. Factor $f_{Rsi=0.25}$ [-]
Mullion fixed	(OM1)		60	0.93	0.032	0.82
Transom fixed	(OT1)		60	0.93	0.034	0.84
Bottom fixed	(FB1)		60	0.95	0.033	0.84
Top fixed	(FH1)		60	0.95	0.033	0.84
Lateral fixed	(FJ1)		60	0.94	0.032	0.82

Spacer: Super Spacer® Premium Secondary seal: Butyl

Thermal glass carrier bridge² $\chi_{GT} = 0.004$ W/K

Validated installations

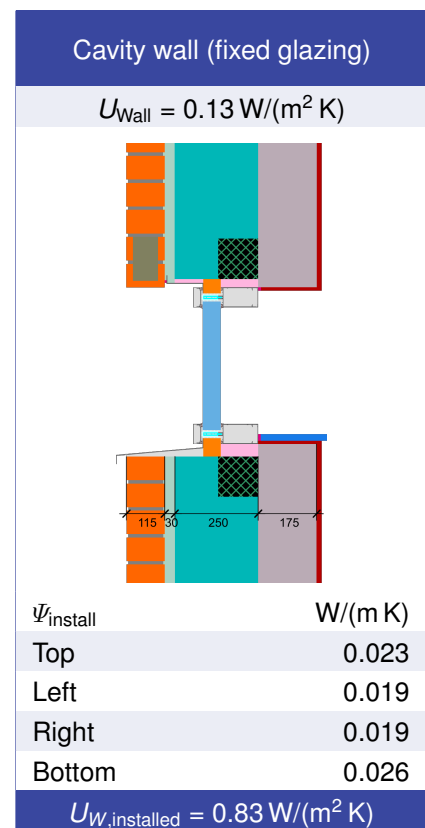
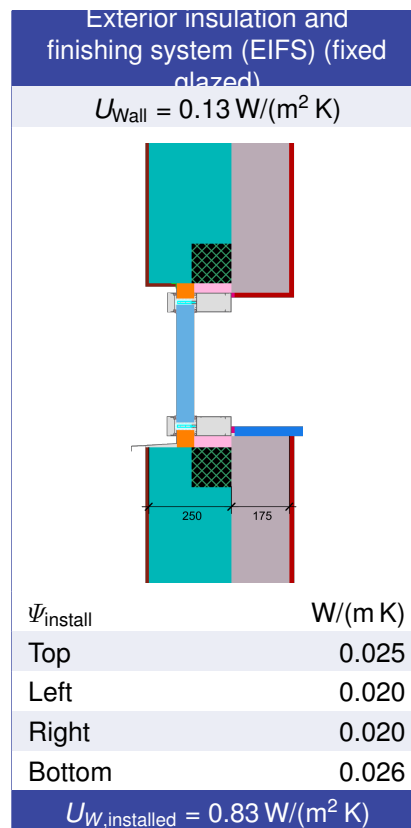
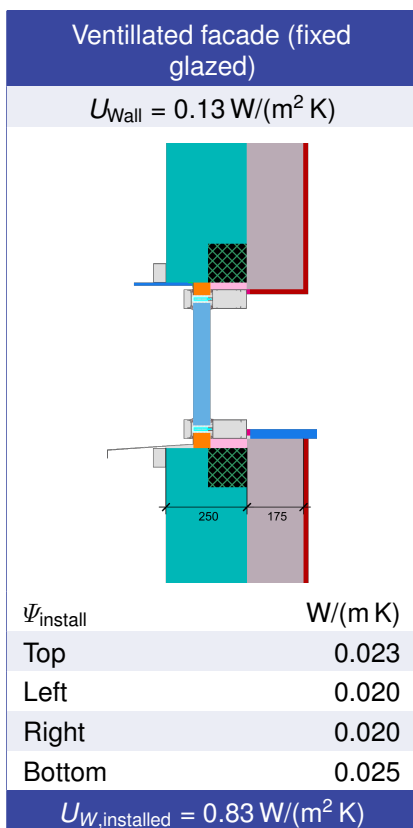

¹ Includes $\Delta U = 0.30$ W/(m² K). Standard value

² Standard value. Glass carrier type: Non-metallic glass carrier with screws

