

CERTIFICATE

Certified Passive House Component

Component-ID 1093wi04 valid until 31st December 2025

Passive House Institute
Dr. Wolfgang Feist
64283 Darmstadt
Germany

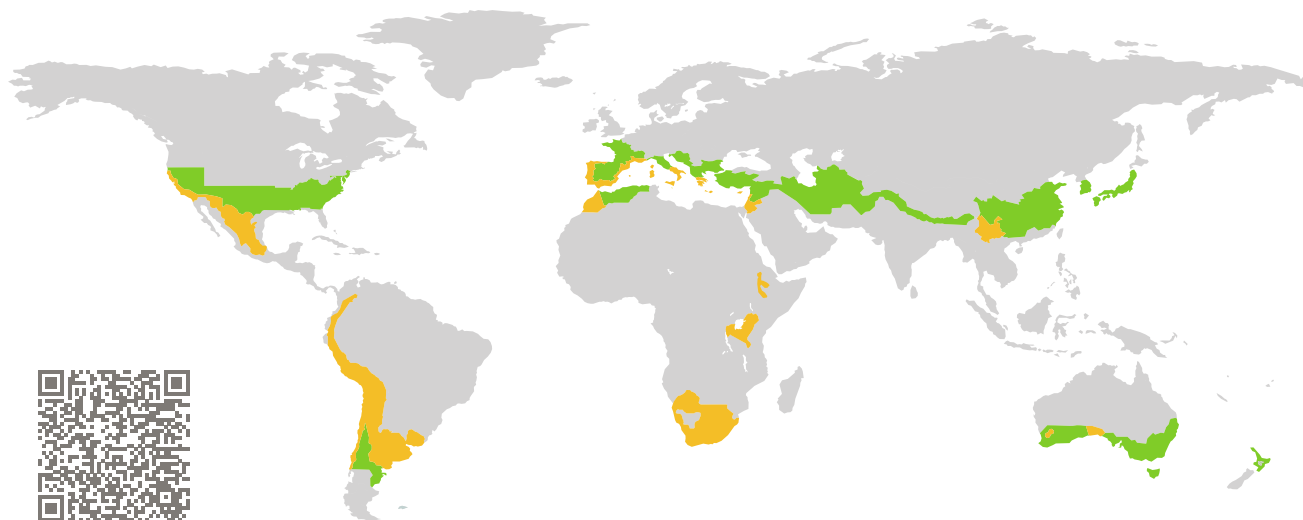

Category: **Window Frame**
Manufacturer: **Logikhaus PTY LTD,
Canberra,
Australia**
Product name: **LogikWin 88**

**This certificate was awarded based on the following
criteria for the warm, temperate climate zone**

Comfort $U_W = 1.00 \leq 1.00 \text{ W}/(\text{m}^2 \text{ K})$
 $U_{W, \text{installed}}$ $\leq 1.05 \text{ W}/(\text{m}^2 \text{ K})$
with U_g $= 0.90 \text{ W}/(\text{m}^2 \text{ K})$

Hygiene $f_{Rsi=0.25} \geq 0.65$

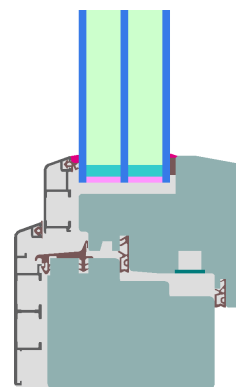

warm, temperate climate

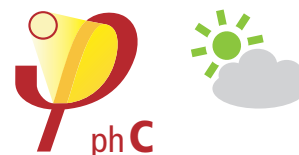

**CERTIFIED
COMPONENT**

Passive House Institute

Passive House
efficiency class

phE

phD

phC

phB

phA

www.passivehouse.com

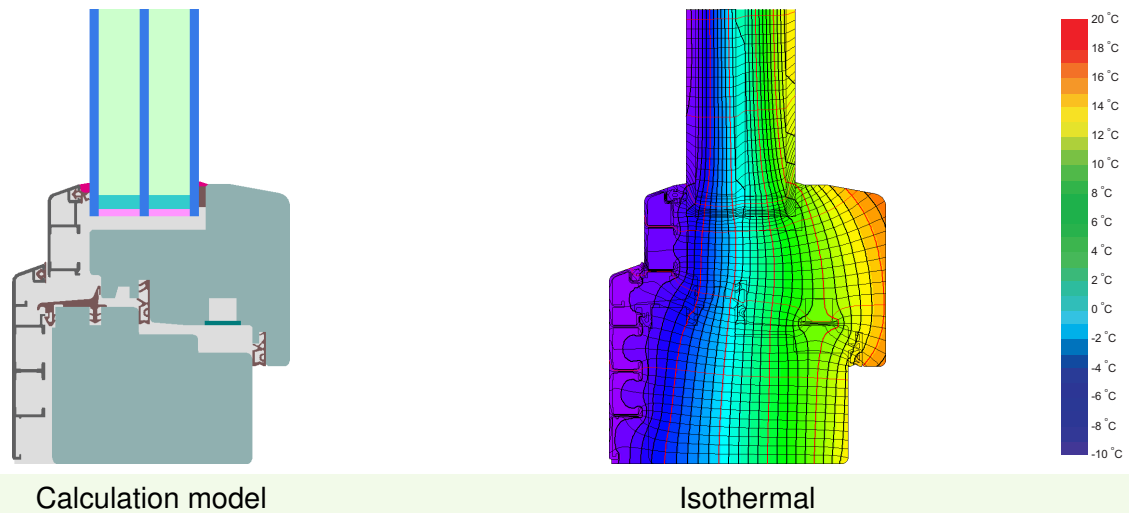

Calculation model Isothermal

Description

Timberframe (0.11 W/(mK)) with aluminium facing shell. Pane thickness: 48 mm (4/18/4/18/4), rebate depth: 14 mm, spacer: SuperSpacer Tri-Seal

Explanation

The window U-values were calculated for the test window size of 1.23 m × 1.48 m with $U_g = 0.90$ W/(m² K). If a higher quality glazing is used, the window U-values will improve as follows:

Glazing	$U_g =$	0.90	0.80	0.70	0.64	W/(m ² K)
		↓	↓	↓	↓	
Window	$U_W =$	1.00	0.93	0.86	0.82	W/(m ² K)

Transparent building components are classified into efficiency classes depending on the heat losses through the opaque part. The frame U-Values, frame widths, thermal bridges at the glazing edge, and the glazing edge lengths are included in these heat losses. A more detailed report of the calculations performed in the context of certification is available from the manufacturer.

The Passive House Institute has defined international component criteria for seven climate zones. In principle, components which have been certified for climate zones with higher requirements may also be used in climates with less stringent requirements. In a particular climate zone it may make sense to use a component of a higher thermal quality which has been certified for a climate zone with more stringent requirements.

Further information relating to certification can be found on www.passivehouse.com and passipedia.org.

Frame values			Frame width b_f mm	U -value frame U_f W/(m ² K)	Ψ -glazing edge Ψ_g W/(m K)	Temp. Factor $f_{RSI=0.25}$ [-]
Mullion fixed	(0M1)		118	1.12	0.022	0.66
Transom fixed	(0T1)		118	1.12	0.022	0.66
Mullion 1 casement	(1M1)		153	1.08	0.022	0.66
Transom 1 casement	(1T1)		153	1.06	0.022	0.65
Mullion 2 casements	(2M1)		188	1.04	0.022	0.67
Transom 2 casements	(2T1)		188	1.06	0.022	0.67
Bottom fixed	(FB1)		88	1.02	0.022	0.66
Top fixed	(FH1)		88	1.07	0.022	0.66
Lateral fixed	(FJ1)		88	1.07	0.022	0.66
Flying Mullion	(FM1)		134	1.10	0.023	0.66
Bottom	(OB1)		123	1.04	0.022	0.72
Top	(OH1)		123	1.03	0.022	0.67
Lateral	(OJ1)		123	1.03	0.022	0.67
Spacer: Super Spacer TriSeal / T-Spacer Premium					Secondary seal: Polysulfide	

Validated installations

Exterior insulation and finishing system

$$U_{\text{Wall}} = 0.23 \text{ W}/(\text{m}^2 \text{ K})$$

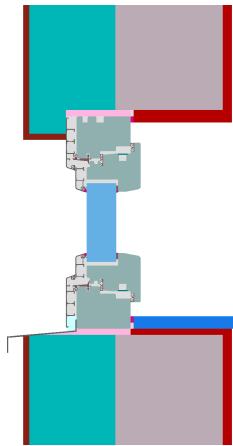

Ψ_{install}	W/(m K)
Top	0.012
Side	0.012
Bottom	0.018

$$U_{W,\text{installed}} = 1.04 \text{ W}/(\text{m}^2 \text{ K})$$

Lightweight timber (operable)

$$U_{\text{Wall}} = 0.24 \text{ W}/(\text{m}^2 \text{ K})$$

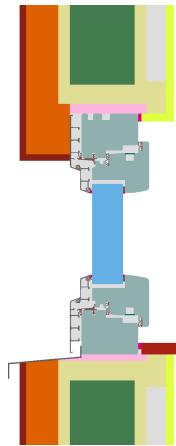

Ψ_{install}	W/(m K)
Top	0.012
Side	0.012
Bottom	0.026

$$U_{W,\text{installed}} = 1.04 \text{ W}/(\text{m}^2 \text{ K})$$

Cavity wall

$$U_{\text{Wall}} = 0.22 \text{ W}/(\text{m}^2 \text{ K})$$

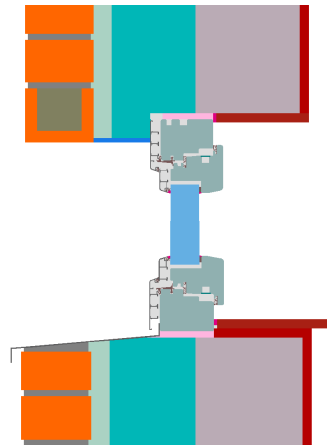

Ψ_{install}	W/(m K)
Top	0.017
Side	0.017
Bottom	0.026

$$U_{W,\text{installed}} = 1.05 \text{ W}/(\text{m}^2 \text{ K})$$